



ANCOR

MARINE

EMERGENCY VEHICLE

INDUSTRIAL

RV

2024

NAVICO GROUP

TAKING YOU FURTHER

Navico Group is the world's leading supplier of integrated systems and products to industries ranging from marine to recreational vehicle and beyond. We offer an unmatched portfolio comprised of industry-leading brands in power management, digital control & monitoring, networked devices and marine electronics.

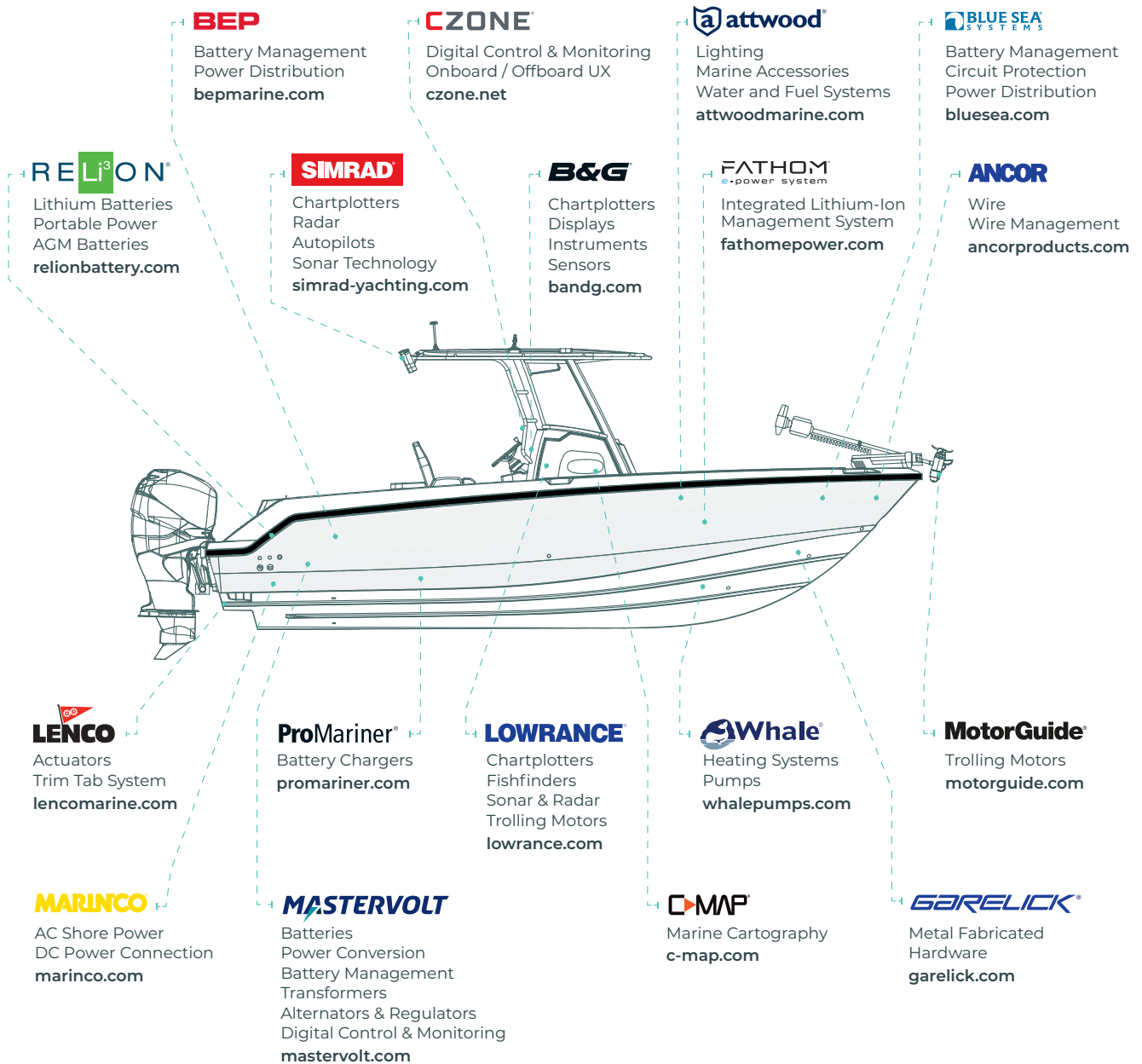

See how far our innovations can take you at Navico.com



What makes Ancor different:

Founder's Vision

For over 40 years Ancor has been the industry leader for quality tinned copper Marine Grade® wire and cable. Ancor's comprehensive product line includes everything required to complete a wiring project. This includes Marine Grade® wire and cable, terminals and connectors, wire management products, and hand tools. Ancor designs products to the highest standards that meet UL, ABYC, NMMA and USCG standards.

Selection

Over 1,500 electrical products are designed to work together as a system

Fast Delivery

Products stocked in multiple global locations ensures rapid order fulfillment

Worldwide Access to Product

A distribution network in over 45 countries provides access to products when they are needed

Information

24-hour access to product information, selection tools, and technical articles online at ancorproducts.com

Industry Standards

Industry involvement ensures products meet ABYC, NMMA, and Coast Guard standards

Quality

Product quality is managed in a manner consistent with international standards

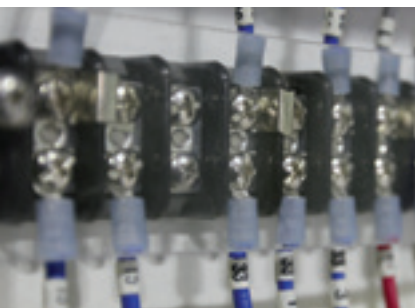

Table of Contents

Wire & Cable

Primary Wire	8
Battery Cable & Assemblies	10
Duplex Cable	12
Triplex Cable	13
Specialty Cable	14
Coax Cable & Assemblies	16
NMEA 2000 Cables & Connectors	18



p. 8



p. 11



p. 13



p. 15



p. 16



p. 18

Terminals & Lugs

Adhesive Lined Heat Shrink Terminals	24
Nylon Insulated Terminals	27
Vinyl Insulated Terminals	29
Tinned Copper Lugs	30
Battery Terminals & Boots	32



p. 24



p. 25



p. 26



p. 27



p. 29



p. 29



p. 29



p. 30



p. 31



p. 32



p. 32

Wire Management

Adhesive Lined Heat Shrink Tubing	36
Adhesive Lined Heavy Wall Heat Shrink Tubing	37
Repair Tape	38
Electrical Tape	38
Cable Ties	39
Cable Clamps	43
Wire Seals	44
Grommets	44
Split Loom & Spiral Wrap	44
Wire Management Kits	45



p. 36



p. 37

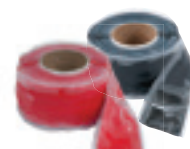

p. 38



p. 38



p. 39



p. 40



p. 41



p. 43



p. 44



p. 44



p. 44

Tools & Testers

Cut/Strip/Crimp Tools	48
Crimpers	50
Mini Fish Tape	51
Tool Kits	53
Heat Tools	52
Pliers & Screwdrivers	53
Digital Multimeters	54
Snap-Around Meters	55



p. 48



p. 48



p. 50



p. 50



p. 52



p. 51



p. 52



p. 51



p. 49



NEW

p. 53



NEW

p. 53



p. 54



p. 55

Displays

Display Racks	56
NMEA 2000	
Planogram Assortment	58



p. 64



p. 65



p. 65



p. 66

Appendix & Index

Technical Data	61
Part Number Index	66

WIRE & CABLE

Primary Wire



8

Manufactured from tinned copper stranding for maximum protection against corrosion and electrolysis. Ultra flexible (Type 3) stranding resists fatigue due to vibration and flexing.

Battery Cable & Assemblies



10

Premium, fine stranded UL1426 tinned copper battery cable for maximum conductivity and flexibility. All assemblies come with tinned copper lugs to avoid corrosion and extend life.

Multiconductor Cables



12

Duplex and triplex wire in a variety of gauge and spool sizes; including UL 1426 tinned duplex boat cable in flat and round configurations.

Specialty Cable



14

Ancor offers a broad range of cable for specialty applications to meet all of your marine and mobile wiring needs.



WIRE & CABLE

Coax Cable & Assemblies



16

Premium tinned copper features signal loss ratios of up to 50% less than other coaxial cables. All assemblies come with Ancor adhesive lined heat shrink to seal out moisture, provide strain relief and fight corrosion.

Trailer Cable & Assemblies



17

Made from our standard Ancor primary wire made specifically for trailer wiring. Assemblies with molded connectors for a wide range of applications.

NMEA 2000 Cables & Connectors



18

Ancor now carries NMEA 2000 cables and connectors for creating or expanding an NMEA 2000 network quickly and easily. Couplers are color coded to make identifying the power cable or connector easy. Premium quality. Universal fit.



Wire and cable are the backbone of every electrical system and properly selected wire will ensure a safe and reliable system.

Ancor Marine Grade® Wire & Cable

- Ancor Marine Grade® wire and cable is manufactured from tinned copper stranding for maximum protection against corrosion and electrolysis. Ultra flexible (Type 3) stranding resists fatigue due to vibration and flexing.
- Ancor's proprietary premium vinyl insulation stays flexible even in extreme cold (-40°F / -40°C) and resists salt water, battery acid, oil, gasoline and ultra-violet radiation. Exclusive insulation is rated at 600 volts, 221°F / 105°C dry and 167°F / 75°C wet, and is resistant to heat and abrasion.
- Exceeds all UL 1426, US Coast Guard Charter boat (CFR Title 46) and ABYC standards.
- See pages 61–65 for ABYC wiring guidelines and technical data.

Primary Wire 18–14 AWG

18 AWG (0.8 mm ²)		
Color	Ft	Part #
Black	35	180003
	100	100010
	250	100025
	500	100050
	1000	100099
Red	35	180803
	100	100810
	250	100825
	500	100850
	1000	100899
Yellow	35	181003
	100	101010
	250	101025
	500	101050
	1000	101099
Green	35	180303
	100	100310
	250	100325
	500	100350
	1000	100399
White	35	180903
	100	100910
	250	100925
	500	100950
	1000	100999
Dk Blue	35	180103
	100	100110
	250	100125
	500	100150
	1000	100199
Brown	35	180203
	100	100210
	250	100225
	500	100250A
	1000	100299
Orange	35	180503
	100	100510
	250	100525
	500	100550
	1000	100599
Pink	35	180603
	100	100610
	250	100625
	500	100650
	1000	100699

18 AWG (0.8 mm ²)		
Color	Ft	Part #
Purple	35	180703
	100	100710
	250	100725
	500	100750
	1000	100799
Grey	35	180403
	100	100410
	250	100425
	500	100450
	1000	100499

16 AWG (1 mm ²)		
Color	Ft	Part #
Black	25	182003
	100	102010
	250	102025
	500	102050
	1000	102099
Red	25	182803
	100	102810
	250	102825
	500	102850
	1000	102899
Yellow	25	183003
	100	103010
	250	103025
	500	103050
	1000	103099
Green	25	182303
	100	102310
	250	102325AA
	500	102350
	1000	102399
White	25	182903
	100	102910
	250	102925
	500	102950
	1000	102999
Dk Blue	25	182103
	100	102110
	250	102125
	500	102150
	1000	102199

16 AWG (1 mm ²)		
Color	Ft	Part #
Brown	25	182203
	100	102210
	250	102225
	500	102250
	1000	102299
Orange	25	182503
	100	102510
	250	102525
	500	102550
	1000	102599
Pink	25	182603
	100	102610
	250	102625
	500	102650
	1000	102699
Purple	25	182703
	100	102710
	250	102725
	500	102750
	1000	102799
Grey	25	182403
	100	102410
	250	102425
	500	102450
	1000	102499
Tan	100	101810
	250	101825
	500	101850
	1000	101890
	1000	101950
Lt Blue	25	181910
	100	101910
	250	101925
	500	101950
	1000	101999

14 AWG (2 mm ²)		
Color	Ft	Part #
Black	18	184003
	100	104010
	250	104025
	500	104050
	1000	104099
Red	18	184803
	100	104810
	250	104825
	500	104850
	1000	104899

14 AWG (2 mm ²)		
Color	Ft	Part #
Yellow	18	185003
	100	105010
	250	105025
	500	105050
	1000	105099
Green	18	184303
	100	104310
	250	104325
	500	104350
	1000	104399
White	18	184903
	100	104910
	250	104925
	500	104950
	1000	104999
Dk Blue	18	184103
	100	104110
	250	104125
	500	104150
	1000	104199
Brown	18	184203
	100	104210
	250	104225
	500	104250
	1000	104299
Orange	18	184503
	100	104510
	250	104525
	500	104550
	1000	104599
Pink	18	184603
	100	104610
	250	104625
	500	104650
	1000	104699
Purple	18	184703
	100	104710
	250	104725
	500	104750
	1000	104799
Grey	18	184403
	100	104410
	250	104425
	500	104450
	1000	104499
Tan	100	103810
	250	103825
	500	103850
	1000	103890
	1000	103950
Lt Blue	100	103910
	250	103925
	500	103950
	1000	103990
	1000	104050



Primary Wire 12–6 AWG

12 AWG (3 mm ²)		
Color	Ft	Part #
Black	12	186003
	25	106002
	100	106010
	250	106025
	400	106040
1000	106099	
Red	12	186803
	25	106802
	100	106810
	250	106825
	400	106840
1000	106899	
Yellow	12	187003
	25	107002
	100	107010
	250	107025
	400	107040
1000	107099	
Green	12	186303
	25	106302
	100	106310
	250	106325
	400	106340
1000	106399	
White	12	186903
	25	106902
	100	106910
	250	106925
	400	106940
1000	106999	
Dk Blue	25	106102
	100	106110
	250	106125
	400	106140
	1000	106199
Brown	25	106202
	100	106210
	250	106225
	400	106240
	1000	106299
Orange	25	106502
	100	106510
	250	106525
	400	106540
	1000	106599
Pink	25	106602
	100	106610
	250	106625
	400	106640
Purple	25	106702
	100	106710
	250	106725
400	106740	
Grey	1000	106499
Tan	100	105810
	250	105825
	400	105840

10 AWG (5 mm ²)		
Color	Ft	Part #
Black	8	188003
	25	108002
	100	108010
	250	108025
	500	108050
1000	108099	
Red	8	188803
	25	108802
	100	108810
	250	108825
	500	108850
1000	108899	
Yellow	25	109002
	100	109010
	250	109025
	500	109050
	1000	109099
Green	25	108302
	100	108310
	250	108325
	500	108350
	1000	108399
White	25	108902
	100	108910
	250	108925
	500	108950
1000	108999	
Dk Blue	25	108102
	100	108110
	250	108125
500	108150	
1000	108199	
Brown	25	108202
	100	108210
	250	108225
	500	108250
1000	108299	
Orange	25	108502
	100	108510
	250	108525
	500	108550
1000	108599	
Grey	1000	108499
	25	109302
	100	109310
	250	109325
Green w/ Yellow Stripe	500	109350
	1000	109399

8 AWG (8 mm ²)		
Color	Ft	Part #
Black	25	111002
	50	111005
	100	111010
	250	111025
	500	111050
1000	111099	
Red	25	111502
	50	111505
	100	111510
	250	111525
	500	111550
1000	111599	
Yellow	25	111902
	50	111905
	100	111910
	250	111925
	500	111950
1000	111999	
Green	25	111302
	50	111305
	100	111310
	250	111325
	500	111350
1000	111399	
White	25	111702
	50	111705
	100	111710
	250	111725
500	111750	
1000	111799	

6 AWG (13 mm ²)		
Color	Ft	Part #
Black	25	112002
	50	112005
	100	112010
	250	112025
	500	112050
750	112075	
Red	25	112502
	50	112505
	100	112510
	250	112525
	500	112550
750	112575	
Yellow	25	112902
	50	112905
	100	112910
	250	112925
	500	112950
750	112975	
Green	25	112302
	50	112305
	100	112310
	250	112325
	500	112350
750	112375	
White	25	112702
	50	112705
	100	112710
	250	112725
500	112750	
750	112775	

TECH TIP

Wire Flexibility Explained

Wire flexibility is influenced by two major factors: wire strand size and jacket hardness.

Wire strand size has the largest impact on overall wire flexibility. As individual wire strand size decreases, wire flexibility increases. For boat cable, UL 1426 requires at least 19 individual strands for cables 16 AWG and larger. Ancor wire uses type 3 stranding which consists of individual 30 AWG (0.010") strands, regardless of the wire gauge. Ancor's 16 AWG wire consists of 26 individual strands, while the 4/0 AWG wire consists of 2,109 individual strands.

Jacket hardness is most commonly measured by durometer, with lower measurements reflecting a more flexible material. Ancor wire measures 7 points lower than competitive product (on a scale of 1-100), resulting in a more flexible product.



Battery Cable 4-4/0 AWG

4 AWG (21 mm²)

Color	Ft	Part #
Black	25	113002
	50	113005
	100	113010
	250	113025
	500	113050
Red	25	113502
	50	113505
	100	113510
	250	113525
	500	113550
Yellow	25	113902
	50	113905
	100	113910
	250	113925
	500	113950

2 AWG (34 mm²)

Color	Ft	Part #
Black	25	114002
	50	114005
	100	114010
	250	114025
	400	114040
Red	25	114502
	50	114505
	100	114510
	250	114525
	400	114540
Yellow	25	114902
	50	114905
	100	114910
	250	114925
	400	114940

1 AWG (42 mm²)

Color	Ft	Part #
Black	25	115002
	50	115005
	100	115010
	300	115030
Red	25	115502
	50	115505
	100	115510
	300	115530
Yellow	25	115902
	50	115905
	100	115910
	300	115930

1/0 AWG (53 mm²)

Color	Ft	Part #
Black	25	116002
	50	116005
	100	116010
	250	116025
	500	116050
Red	25	116502
	50	116505
	100	116510
	250	116525
	500	116550
Yellow	25	116902
	50	116905
	100	116910
	250	116925
	500	116950

2/0 AWG (68 mm²)

Color	Ft	Part #
Black	25	117002
	50	117005
	100	117010
	200	117020
Red	25	117502
	50	117505
	100	117510
	200	117520
Yellow	25	117902
	50	117905
	100	117910
	200	117920

3/0 AWG (85 mm²)

Color	Ft	Part #
Black	25	118002
	50	118005
	100	118010
	150	118015
	300	118030
Red	25	118502
	50	118505
	100	118510
	150	118515
	300	118530
Yellow	25	118902
	50	118905
	100	118910
	150	118915
	300	118930

4/0 AWG (107 mm²)

Color	Ft	Part #
Black	25	119002
	50	119005
	100	119010
	250	119025
Red	25	119502
	50	119505
	100	119510
	250	119525
Yellow	25	119902
	50	119905
	100	119910
	250	119925

Related Products



Battery Terminals page 32



Lugs page 30



Heat Shrink Tubing page 36



Premium Electrical Tape page 38

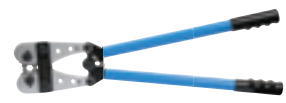

Cutting & Crimping Tools pages 48-51

18-4/0 AWG Wire and Cable Specifications

Wire Size	Nominal O.D.	Wire Diameter	Minimum Bend Radius	Stranding No. of 30 AWG	Cir. Mil Area	Ohms per 1000'	mm ²	Wt. per 1000'				
18 AWG	.08 mm ²	7/64"	2.8 mm	1.0 mm	7/8"	2.3 cm	16	1600	6.48	.08	12 lbs	5.4 kg
16 AWG	1 mm ²	1/8"	3.2 mm	1.5 mm	31/32"	2.5 cm	26	2600	4.00	1.31	16 lbs	7.3 kg
14 AWG	2 mm ²	9/64"	3.6 mm	2.0 mm	1-3/32"	2.8 cm	41	4100	2.53	2.08	23 lbs	10.4 kg
12 AWG	3 mm ²	5/32"	4.0 mm	2.6 mm	1-1/4"	3.2 cm	65	6500	1.75	3.31	31 lbs	14 kg
10 AWG	5 mm ²	7/32"	5.6 mm	3.3 mm	1-29/64"	3.7 cm	105	10,500	1.00	5.26	44 lbs	20 kg
8 AWG	8 mm ²	5/16"	7.9 mm	4.3 mm	2-1/32"	5.2 cm	168	16,800	0.62	8.37	86 lbs	39 kg
6 AWG	13 mm ²	11/32"	8.7 mm	5.5 mm	2-35/64"	6.5 cm	266	26,600	0.40	13.30	118 lbs	53.5 kg
4 AWG	21 mm ²	13/32"	10.3 mm	7.0 mm	3-3/32"	7.9 cm	420	42,000	0.24	21.15	178 lbs	81 kg
2 AWG	34 mm ²	15/32"	11.9 mm	8.0 mm	3-1/2"	8.9 cm	665	66,500	0.16	33.62	277 lbs	126 kg
1 AWG	42 mm ²	17/32"	13.5 mm	9.0 mm	4-9/64"	10.4 cm	836	83,690	0.13	42.38	350 lbs	159 kg
1/0 AWG	53 mm ²	9/16"	14.3 mm	10.5 mm	4-1/2"	11.4 cm	1064	105,600	0.10	53.49	437 lbs	198 kg
2/0 AWG	68 mm ²	5/8"	15.9 mm	12.0 mm	4-59/64"	12.4 cm	1330	133,000	0.08	67.43	549 lbs	249 kg
3/0 AWG	85 mm ²	11/16"	17.5 mm	13.0 mm	5-23/64"	13.7 cm	1665	167,800	0.06	85.01	675 lbs	306 kg
4/0 AWG	107 mm ²	13/16"	20.6 mm	14.0 mm	5-7/8"	15.0 cm	2109	211,600	0.05	107.20	837 lbs	380 kg



Premium Battery Cable Assemblies

UL1426 Tinned Boat Cable

- Premium, fine stranded UL 1426 tinned copper battery cable for maximum conductivity and flexibility
- Flame retardant, UV inhibited cable rated at 600V and 221°F / 105°C
- Tinned copper lugs to avoid corrosion and extend life
- 3:1 heat shrink tubing over the electrical connection to seal out moisture and provide strain relief

Color	Length	Stud Size	Part #
4 AWG (21 mm²)			
Black	18"	45.7 cm	5/16" 7.93 mm 189130
	32"	81.2 cm	5/16" 7.93 mm 189134
	48"	121.9 cm	5/16" 7.93 mm 189136
Red	18"	45.7 cm	3/8" 9.5 mm 189131
	32"	81.2 cm	3/8" 9.5 mm 189135
	48"	121.9 cm	3/8" 9.5 mm 189137

Color	Length	Stud Size	Part #
2 AWG (34 mm²)			
Black	18"	45.7 cm	5/16" 7.93 mm 189140
	32"	81.2 cm	5/16" 7.93 mm 189144
	48"	121.9 cm	5/16" 7.93 mm 189146
Red	18"	45.7 cm	3/8" 9.5 mm 189141
	32"	81.2 cm	3/8" 9.5 mm 189145
	48"	121.9 cm	3/8" 9.5 mm 189147

For continuous current draws up to:	Use battery cable assemblies
136 amps	4 AWG
178 amps	2 AWG

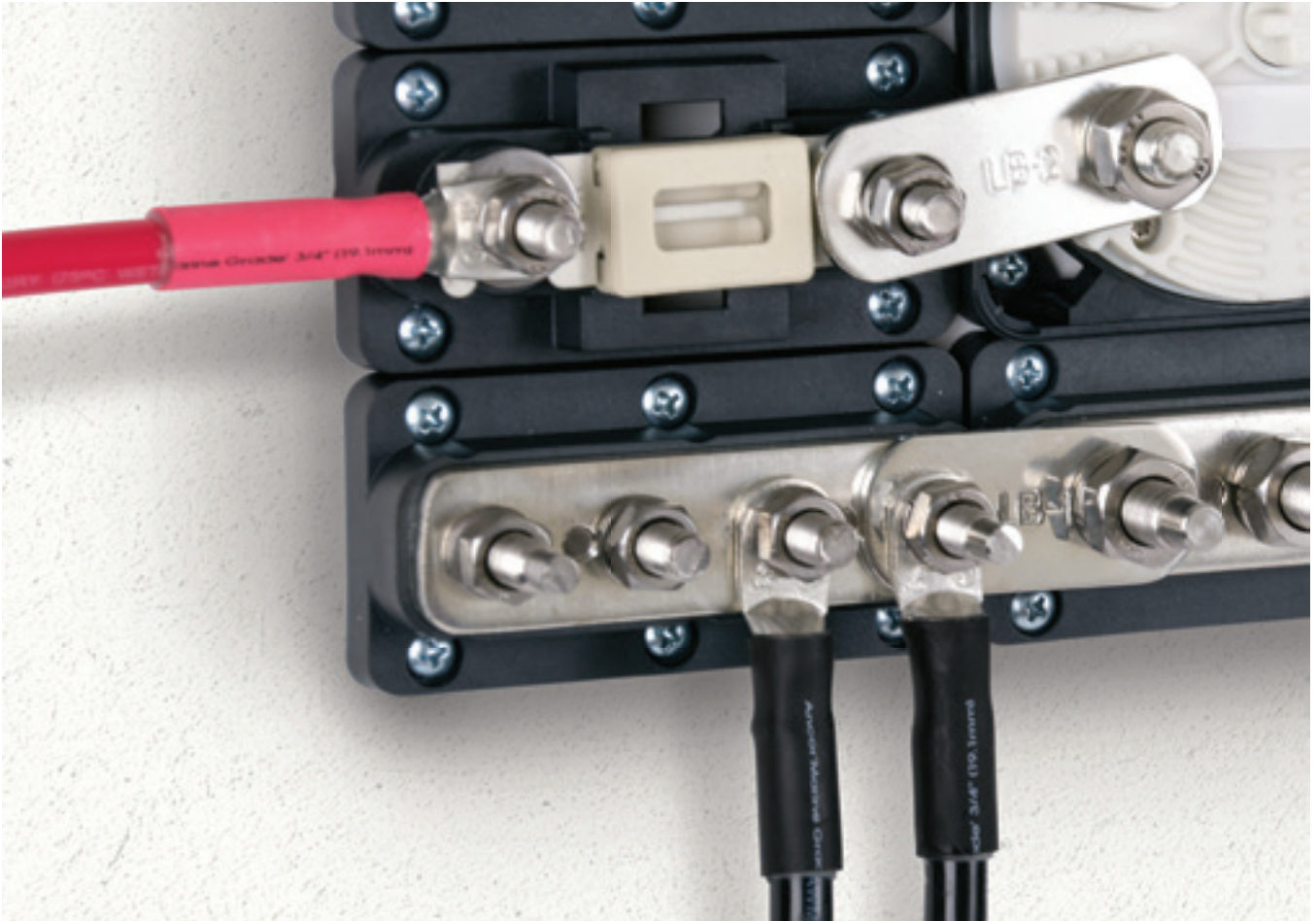

Safety Duplex Cable

UL 1426 Tinned Boat Cable

Conductor colors: red and yellow

Flat Cable



Spool Length	Part #	Nominal O.D.	Wt. per 1000'
18/2 AWG (2x0.8 mm²)			
100'	124910		
250'	124925	3/16"x9/32"	49 lbs
500'	124950	5x7 mm	22.2 kg
1000'	124999		
16/2 AWG (2x1 mm²)			
25'	124702		
100'	124710		
250'	124725	3/16"x5/16"	51 lbs
500'	124750	5x8 mm	23.1 kg
1000'	124799		
14/2 AWG (2x2 mm²)			
25'	124502		
100'	124510		
250'	124525	7/32"x11/32"	65 lbs
500'	124550	6x9 mm	29.5 kg
1000'	124599		

Spool Length	Part #	Nominal O.D.	Wt. per 1000'
12/2 AWG (2x3 mm²)			
25'	124302		
100'	124310	7/32"x3/8"	82 lbs
250'	124325	6x10 mm	37.3 kg
500'	124350		
10/2 AWG (2x5 mm²)			
25'	124102		
100'	124110		
250'	124125	1/4"x15/32"	128 lbs
400'	124140	6x12 mm	58.2 kg
800'	124180		
8/2 AWG (2x8 mm²)			
50'	123905		
100'	123910	11/32"x5/8"	230 lbs
500'	123950	9x16 mm	104.5 kg
6/2 AWG (2x13 mm²)			
50'	123705	13/32"x3/4"	364 lbs
100'	123710	10x19 mm	165.5 kg

Round Cable



Spool Length	Part #	Nominal O.D.	Wt. per 1000'
16/2 AWG (2x1 mm²)			
100'	126710		
250'	126725	5/16"	49 lbs
500'	126750	8 mm	22.2 kg
14/2 AWG (2x2 mm²)			
100'	126510		
250'	126525	11/32"	63 lbs
500'	126550	9 mm	28.6 kg

Spool Length	Part #	Nominal O.D.	Wt. per 1000'
12/2 AWG (2x3 mm²)			
100'	126310		
250'	126325	13/32"	80 lbs
500'	126350	10 mm	36.3 kg

Duplex Cable

Conductor colors: black and red

Flat Cable



Spool Length	Part #	Nominal O.D.	Wt. per 1000'
18/2 AWG (2x0.8 mm²)			
100'	121910		
250'	121925	3/16"x9/32"	49 lbs
500'	121950	5x7 mm	22.2 kg
16/2 AWG (2x1 mm²)			
100'	121710		
250'	121725	3/16"x5/16"	51 lbs
500'	121750	5x8 mm	23.1 kg
1000'	121799		
14/2 AWG (2x2 mm²)			
100'	121510		
250'	121525	7/32"x11/32"	65 lbs
500'	121550	6x9 mm	29.5 kg
1000'	121599		

Spool Length	Part #	Nominal O.D.	Wt. per 1000'
12/2 AWG (2x3 mm²)			
100'	121310		
250'	121325	7/32"x3/8"	82 lbs
500'	121350	6x10 mm	37.3 kg
10/2 AWG (2x5 mm²)			
100'	121110		
250'	121125	1/4"x15/32"	128 lbs
400'	121140	6x12 mm	58.2 kg
800'	121180		
8/2 AWG (2x8 mm²)			
50'	120905		
100'	120910	11/32"x5/8"	230 lbs
250'	120925	9x16 mm	104.5 kg
6/2 AWG (2x13 mm²)			
50'	120705	13/32"x3/4"	364 lbs
100'	120710	10x19 mm	165.5 kg

Triplex Cable

Conductor colors: black, green and white

Flat Cable



Spool Length	Part #	Nominal O.D.	Wt. per 1000'
16/3 AWG (3x1 mm²)			
100'	131710		
250'	131725	3/16"x15/32"	75 lbs
500'	131750	5x12 mm	34 kg
1000'	131799		
14/3 AWG (3x2 mm²)			
100'	131510		
250'	131525	7/32"x1/2"	96 lbs
500'	131550	6x13 mm	43.6 kg
900'	131590		
12/3 AWG (3x3 mm²)			
25'	131302		
100'	131310	7/32"x17/32"	125 lbs
250'	131325	6x14 mm	56.8 kg
700'	131370		

Spool Length	Part #	Nominal O.D.	Wt. per 1000'
10/3 AWG (3x5 mm²)			
100'	131110		
300'	131130	1/4"x21/32"	186 lbs
500'	131150	6x17 mm	84.5 kg
8/3 AWG (3x8 mm²)			
25'	130902		
50'	130905	3/8"x1"	287 lbs
100'	130910	10x25 mm	130.4 kg
6/3 AWG (3x13 mm²)			
50'	130705	7/16"x1-3/16"	470 lbs
100'	130710	11x30 mm	213.6 kg

Round Cable



Spool Length	Part #	Nominal O.D.	Wt. per 1000'
16/3 AWG (3x1 mm²)			
100'	133710	11/32"	75 lbs
250'	133725	9 mm	34 kg
14/3 AWG (3x2 mm²)			
100'	133510		
250'	133525	13/32"	96 lbs
900'	133590	10 mm	43.6 kg

Spool Length	Part #	Nominal O.D.	Wt. per 1000'
12/3 AWG (3x3 mm²)			
100'	133310	7/16"	125 lbs
250'	133325	11 mm	56.8 kg

Related Products



Cutting & Stripping Tools
pages 49-51



Wire Seals
page 44

TECH TIP

Round versus Flat Duplex/Triplex

Duplex and triplex cable have many different advantages to help installers. The grouped wires save time and effort by having to run only one group instead of multiple individual wires and also provides extra protection for the wire itself. But they have different advantages based on the shape too. Round cable for instance is easier to install through bulk heads, walls, panels or holes, while flat cable is easier to route long distances since it can be moved through a smaller space.



Specialty Cable



Bonded Cable

Tinned Copper

Color conductors: red and black

Spool Length	Part #	Nominal O.D.	Wt. per 1000'
8/2 AWG (2x8 mm²)			
25'	121802		
100'	121810	5/8"x5/16"	172 lbs
250'	121825	15.9x7.9 mm	78.0 kg
6/2 AWG (2x13 mm²)			
25'	121602A		
100'	121610	11/16"x11/32"	236 lbs
250'	121625	17.5x8.7 mm	107.0 kg



Twisted Pairs w/ Shield

Premium Tinned Copper

Color conductors: red and black

- For all metal boats and around sensitive electronics
- 93% tinned copper shield for maximum EMI and RFI rejection
- 2-3" lay for interference cancellation

Spool Length	Part #	Nominal O.D.	Wt. per 1000'
14/2 AWG (2x2 mm²)			
100'	141410	.330"	73.2 lbs
250'	141425	8.4 mm	33.3 kg



Flat Ribbon Bonded Cable

Premium Tinned Bonded Copper

Conductor colors: red and black

Spool Length	Part #	Nominal O.D.	Wt. per 1000'
16/2 AWG (2x1 mm²)			
100'	153110		
250'	153125	1/8"x1/4"	32 lbs
500'	153150	3.2x6.4 mm	14.5 kg



Round Mast

UL 1426 Tinned Boat Cable

Color conductors: black, blue, green, brown and red

Spool Length	Part #	Nominal O.D.	Wt. per 1000'
14/5 AWG (5x2 mm²)			
100'	155010	1/2"	160 lbs
500'	155050	12.7 mm	79.5 kg



Round Instrument Cable

100% Mylar Foil Shield & Drain Wire

UL 1426 Tinned Boat Cable

Color conductors: red, black and bare

Spool Length	Part #	Nominal O.D.	Wt. per 1000'
20/3 AWG (3x0.5 mm²)			
100'	153010	7/32"	30 lbs
500'	153050	5.6 mm	13.6 kg



Round Signal

100% Mylar Foil Shield and

Drain Tinned Boat Cable

Conductor colors: black, red, green, blue, brown, orange, purple and yellow

Spool Length	Part #	Nominal O.D.	Wt. per 1000'
20/8 AWG (8x0.5 mm²)			
100'	158010	5/16"	63 lbs
250'	158025	7.9 mm	28.6 kg



Signal Cable

Tinned Boat Cable

Conductor colors: red and black

Spool Length	Part #	Nominal O.D.	Wt. per 1000'
20/2 AWG (2x0.5 mm²)			
25'	189303		
100'	122010	5/32"x1/4"	18 lbs
250'	122025	4x6.4 mm	8.1 kg
500'	122050		



Bilge Pump Cable

Premium Tinned Copper

Color conductors: black, brown and red
Insulation: grey

- Conductors specifically for bilge pumps
- Oil resistant
- SJTOW-A water resistant jacket

Spool Length	Part #	Nominal O.D.	Wt. per 1000'
16/3 AWG (3x1 mm²)			
100'	156610	.348"	78 lbs
250'	156625	8.85 mm	35.5 kg
14/3 AWG (3x2 mm²)			
100'	156410	.377"	99 lbs
250'	156425	9.6 mm	45.0 kg
500'	156450		



Flat Ribbon Bonded RGB Cable

Tinned Copper

Conductor colors: red, light blue, green, and white

Spool Length	Part #	Nominal O.D.	Wt. per 1000'
18/4 AWG (4x0.08 mm²)			
100'	160010	3/32"x3/8"	48 lbs
1000'	160099	2.3x9.3 mm	21.8 kg
16/4 AWG (4x1 mm²)			
100'	160110	1/8"x15/32"	64 lbs
1000'	160199	2.6x10.5 mm	29.0 kg
14/4 AWG (4x2 mm²)			
100'	160210	7/64"x15/32"	92 lbs
1000'	160299	3.0x11.9 mm	41.7 kg



Super Flex Audio Cable

Premium Tinned Copper

- Super flexible, easy to run
- Clear jacket to blend into the environment
- Drawn copper, unidirectional lay for ultimate in sound quality
- Tinned copper for corrosion resistance in the marine environment

Spool Length	Part #	Nominal O.D.	Wt. per 1000'
18/2 AWG (2x0.8 mm²)			
100'	142810	.265"	29 lbs
		6.7 mm	13 kg
16/2 AWG (2x1 mm²)			
100'	142610	.319"	51 lbs
250'	142625	8.1 mm	23.1 kg
500'	142650		
14/2 AWG (2x2 mm²)			
100'	142410	.345"	65 lbs
250'	142425	8.8 mm	29.5 kg
1000'	142499		



RGB + Speaker Cable

Tinned Copper

18 AWG conductors for RGB lighting: yellow, red, blue, green

16 AWG conductors for speaker connections: black and red

- Saves time by running only one cable
- Meets ABYC standards

Spool Length	Part #	Nominal O.D.	Wt. per 1000'
18/4 AWG (4x0.08 mm²) + 16/2 AWG (2x1 mm²)			
25'	170002		
100'	170010	.352"	69.9 lbs
		8.9 mm	31.7 kg
250'	170025		



GTO 15 High Voltage Cable (15000V)

Color conductors: white

- Coupler output to antenna

Spool Length	Part #	Nominal O.D.	Wt. per 1000'
14 AWG (2 mm²)			
25'	150102	1/4"	38 lbs
100'	150110	6.4 mm	17.2 kg





Shore Power Cord

Conductor colors: black, white, green (and red 100319 only)

- High visibility yellow jacket is weather and sunlight resistant
- Ultra flexible insulation is abrasion resistant for "hard service" applications
- 600 volt rated for extra heavy-duty service
- 16/3 is 300 volt cable
- Temp rating: 140°F / 60°C

Spool Length	Part #	Nominal O.D.	Wt. per 1000'
10/3 STOW			
100'	153710	21/32"	284 lbs
250'	153725	17 mm	129 kg
10/3 STW			
250'	SPC103	21/32" 17 mm	284 lbs 129 kg

Spool Length	Part #	Nominal O.D.	Wt. per 1000'
6/3 STW			
per/ft**	100320F	31/32" 24.4 mm	540 lbs 254.4 kg
6/4 STW			
per/ft**	100319F	1-5/64" 27.4 mm	695 lbs 316 kg

SPC103, 100320F and 100319F are not tinned wire
**50 ft minimum

Coaxial Cable & Assemblies

Coaxial Cable

Premium Tinned Copper

- Features signal loss ratios of up to 50% less than other coaxial cables
- Tinned copper center conductor as well as tinned copper outer braid for corrosion resistance and easy soldering
- 96% braid for best signal strength and least interference with UV inhibited white jacket for longest life



Spool Length	Part #	Nominal O.D.	Wt. per 1000'
RG 58CU			
100'	150510	3/16"	26 lbs
250'	150525	4.8 mm	11.8 kg
RG 59U			
250'	151025	1/4"	36 lbs
500'	151050	6.4 mm	16.3 kg
RG 8X			
100'	151510		
250'	151525	1/4"	40 lbs
500'	151550	6.4 mm	18.1 kg
1000'	151560		
RG 213			
100'	151710		
250'	151725	13/32" 10.3 mm	110 lbs 50 kg
500'	151750		

Coaxial Cable Assemblies

Premium Tinned Copper

- All assemblies come with Ancor adhesive lined heat shrink to seal out moisture, provide strain relief and fight corrosion
- 96% tinned copper braid for optimum protection against signal loss
- 100% tinned copper center conductor and braid
- No solder or special tools required
- Special low loss SAT NAV extensions



Wire Type	RG58C/U	RG59U	RG8X	RG213
Insulation Material	PVC*	PVC	PVC	PVC*
Nominal O.D.	3/16" 4.8 mm	1/4" 6.4 mm	1/4" 6.4 mm	13/32" 10.3 mm
AWG	20	23	16	13
Conductor Stranding	19/33	Solid**	19/29	7/21
Braid Coverage	96%	96%	96%	96%
Wt. per 1000'	26 lbs 11.8 kg	36 lbs 16.3 kg	40 lbs 18.1 kg	110 lbs 50 kg
Impedance (Ohms)	50	75	50	50
Capacitance/Ft.	30.8 pF	20.5 pF	26.0 pF	30.8pF
Attenuation/100'				
@50MHz	3.3db	2.4db	2.5db	1.3db
@100MHz	4.9db	3.4db	3.7db	1.9db
@1000MHz	21.5db	12.0db	13.5db	8.0db
Velocity of Propagation	66%	66%	78%	66%

* non-contaminating insulation ** copperweld

TECH TIP

Ancor Recommends

- RG 58CU for interconnecting electronic equipment
- RG 59U for TVs and some SAT NAVs
- RG 213 for VHF runs more than 50 feet
- RG 8X for VHF runs less than 50 feet

Ends Description	Wire Length	Part #
RG58CU Two ends assembled	3'	189800
RG8X One end assembled	50'	189849

Trailer Cable & Assemblies



Flat Ribbon Bonded Trailer Cable

Premium Tinned Bonded Copper

Conductor colors: brown, green, white, and yellow

Spool Length	Part #	Nominal O.D.	Wt. per 1000'
16/4 AWG (4x1 mm²)			
100'	154510	1/8"x1/2"	29.2 lbs
250'	154525	3.2x12.7 mm	13.2 kg



Flat Trailer Cable

Tinned Boat Cable

Conductor colors: yellow, white, green, and brown

Spool Length	Part #	Nominal O.D.	Wt. per 1000'
16/4 AWG (4x1 mm²)			
100'	154010	3/16"x9/16"	105 lbs
300'	154030	4x14 mm	47.7 kg

Trailer Assemblies

- Molded trailer connectors are made with 16 gauge wire
- Color coding in accordance with SAE recommended practices
- Male Connector = Trailer Side / Female Connector = Vehicle Side
- 4-contact connectors are molded with an EasyGrip® for fast and easy disconnect
- Loops can be cut to the desired length for splicing into an existing wire assembly

2-wire



male female

length	style	part #
12"	loop	249102

4-wire



male female

length	style	part #
12"	loop	249101

NMEA 2000® Cables and Connectors

Premium Quality. Universal Fit.

Ancor NMEA 2000 approved cables and connectors simplify creating or expanding an NMEA 2000 network. Couplers are color coded to make identifying the power cable or connector easy once installed as part of an NMEA 2000 network. The color coded couplers connect to the corresponding Ancor cables and connectors creating an easy to identify network.

- NMEA 2000 Approved, 100% universal and compatible with other manufacturers' products
- NMEA micro-size



NMEA 2000 Power Cable With Tee

For power connection to an NMEA 2000 network.

The tee is color coded red to make identifying the power cable easy once installed as part of an NMEA 2000 network. The yellow couplers connect to the corresponding Ancor backbone cables and tees creating a simplified, color coded network installation.

- Includes a tee for direct connection to backbone cables
- Large 18 AWG power conductors to reduce voltage drop, provide better reliability and meet the requirements of ABYC and the USCG for minimum size power conductors

Part # 270000 3.3 ft 1 m

Ancor NMEA 2000 Color Key:

- = power connection
- = backbone connection
- = drop connection
- = power isolation
- = inline termination

Backbone vs Drop Cables



NMEA 2000 Backbone Cables

For connection to an NMEA 2000 tee connector.

The yellow couplers connect to the corresponding Ancor tees creating a simplified, color coded network installation.

- Large 18 AWG power conductors to reduce voltage drop and provide better reliability for critical backbone cables

Part # 270001 1.6 ft .5 m
 Part # 270002 6.5 ft 2 m
 Part # 270005 16 ft 5 m
 Part # 270010 32 ft 10 m



NMEA 2000 Drop Cables

For connection between an NMEA 2000 device and tee connector.

The black couplers connect to the corresponding Ancor tees creating a simplified, color coded network installation. The drop cables are smaller in diameter and more flexible than backbone cables for easy connection to NMEA 2000 devices.

- Super flexible 22 AWG power conductors for ease of installation and wire routing

Part # 270300 1.6 ft .5 m
 Part # 270301 3.3 ft 1 m
 Part # 270302 6.5 ft 2 m
 Part # 270305 16 ft 5 m



APPROVED

NMEA 2000 Tee Connectors

For connection between NMEA 2000 drop cables and backbone cables.

The yellow couplers connect to the corresponding Ancor tees and backbone cables, creating a simplified, color coded network installation. The connectors are offered in four configurations for maximum installation flexibility. The two way and four way tee connectors allow for multiple drop cables to be connected without additional backbone cable.

- Part # 270101 Single Tee Connector
- Part # 270103 2 Way Tee Connector
- Part # 270104 4 Way Tee Connector



270101



270103



270104



APPROVED

NMEA 2000 Terminators

For proper termination of an NMEA 2000 network.

The yellow couplers connect to the corresponding Ancor tees, creating a simplified, color coded network installation. One male and one female terminator is required for each NMEA 2000 network.

- Part # 270105 Female
- Part # 270106 Male



270105



270106

NMEA 2000 Inline Terminator

For proper termination of a network in a single piece, space saving design.

The inline terminator connects between a backbone cable and a drop cable, while still maintaining proper termination for the end of the network.

- Part # 270114



NMEA 2000 Blanking Caps

Cover unused couplers.

Protects unused tee connectors from dust and water. 2-pack.

- Part # 270111 Female
- Part # 270112 Male



270111 270112



APPROVED

NMEA 2000 90° Elbow Connector

Makes cable routing easier.

The connector is installed between two cables to reduce stress on the cables and create a compact installation.

- Part # 270108



NMEA 2000 Field Serviceable Connectors

For termination of bare NMEA cable.

Securely terminate bulk cable, or replace a broken end.

- Part # 270109 Female
- Part # 270110 Male



270109



270110

NMEA 2000 Through Bulkhead Adaptor

Use for transitions through bulk heads or panels.

Simplifies installation when routing through a waterproof bulkhead or panel. Creates a connectoin point for removable equipment such as a computer interface.

- Part # 270107



NMEA 2000 Power Isolator

Isolating power within a NMEA 2000 network.

The power isolator connects between NMEA 2000 tees and backbone cables while isolating the power supply within the network.

- Part # 270113



NMEA 2000® Starter Kits



NMEA 2000 Single Device Starter Kit

Kit include all components needed to create a single device NMEA 2000 network.

Kit includes:

- (1) Power Cable with Tee, 3.3 ft (1m), part # 270000
- (1) Male Terminator, part # 270106
- (1) Female Terminator, part # 270105
- (1) Single Tee Connector, part # 270101
- (1) Drop Cable, 6.5 ft (2m), part # 270302

Part # 270201

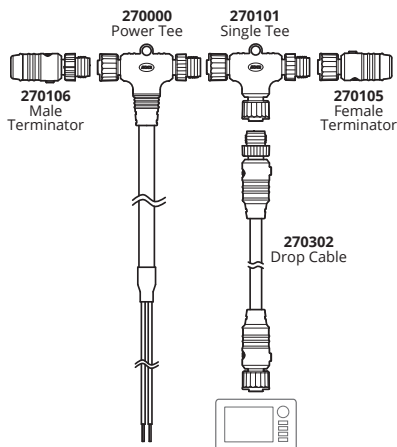

NMEA 2000 Dual Device Starter Kit

Kit include all components needed to create a dual device NMEA 2000 network.

Kit includes:

- (1) Power Cable with Tee, 3.3 ft (1m), part # 270000
- (1) Male Terminator, part # 270106
- (1) Female Terminator, part # 270105
- (1) Dual Tee Connector, part # 270103
- (2) Drop Cable, 6.5 ft (2m), part # 270302

Part # 270202

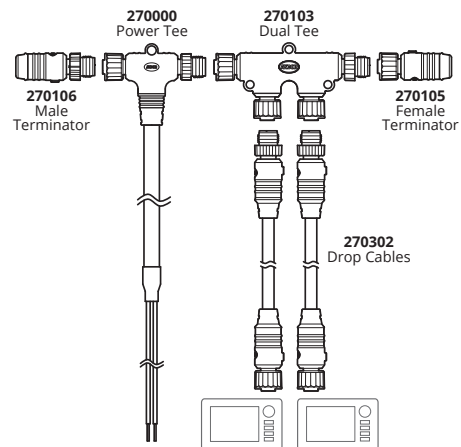



NMEA 2000® Single Device Backbone Starter Kit

Basic starter kit for adding a new NMEA 2000 network to your boat.

Kit includes:

- (1) Power Cable with Tee, 3.3 ft (1m), part # 270000
- (1) Male Terminator, part # 270106
- (1) Female Terminator, part # 270105
- (1) Single Tee Connector, part # 270101
- (1) Drop Cable, 1.64 ft (.5m), part # 270300
- (1) Backbone Cable, 16.4 ft (5m), part # 270005

Part # 270203

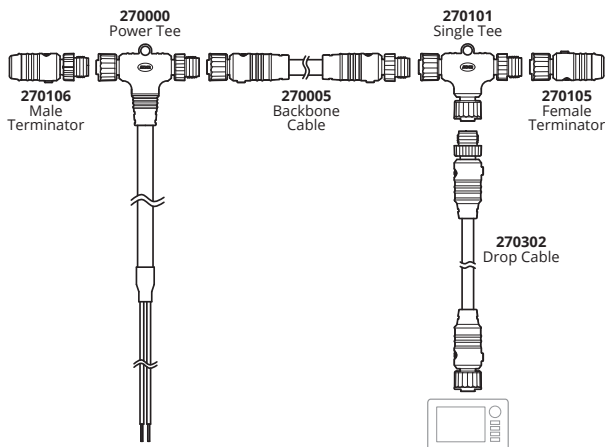

TECH TIP

Approved vs Certified

NMEA Components—cables and connectors must pass NMEA approval to guarantee that they are manufactured to standards which allow them to be universally used with any manufacturers approved components and certified devices.

NMEA Devices—must be certified to run the universal NMEA 2000 communications protocols to be used universally between different manufacturers devices.



TERMINALS & LUGS

Adhesive Lined Heat Shrink Terminals



24

Includes a heat activated adhesive built into the sleeve of the tubing for improved seal and strain relief.

Nylon Insulated Terminals



27

Marine Grade® Nylon terminals are designed for harsh boating applications. Nylon insulators are ideal for crimping and will not split.

Vinyl Insulated Terminals



29

Ideal for non-waterproof applications.



TERMINALS & LUGS

Tinned Copper Lugs



30

Ancor Marine Grade® lugs are made from heavy-duty annealed tinned copper for maximum current flow and corrosion resistance.

Heavy-duty Butt Connectors



30

Use with larger gauge cable for proper connection.

Battery Terminals, Covers & Clips



32

Provides proper connections to batteries for maximum conductivity.



Electrical systems rely on Ancor terminals and lugs to securely connect a vessels' electrical system so current-carrying loads swiftly move from the source of power to the loads.

Adhesive Lined Heat Shrink Terminals

- Heat activated adhesive built into the sleeve of the heat shrink tubing
- Shrinks to form a water tight seal and ultimate vibration and strain relief
- Tinned for corrosion resistance
- Pure copper for maximum current flow
- Brazed seam for maximum strength
- UL listed and CSA recognized
- Shrinks at 275°F / 135°C



Heat Shrink Ring Terminals

- UL 486A

AWG	Screw Size	Qty/ Pkg	Part #
22-18 0.3-0.8 mm ²	#8 4 mm	3	310203
		25	310225
		100	310299
	#10 4.8 mm	3	310303
		25	310325
		100	310399
	1/4" 6.4 mm	3	310403
		25	310425
		100	310499
		3	310503
		25	310525
		100	310599
5/16" 7.9 mm	3	310603	
	25	310625	
	100	310699	
16-14 1-2 mm ²	#8 4 mm	3	311203
		25	311225
		100	311299
	#10 4.8 mm	3	311303
		25	311325
		100	311399
	1/4" 6.4 mm	3	311403
		25	311425
		100	311499
		3	311503
		25	311525
		100	311599
5/16" 7.9 mm	3	311603	
	25	311625	
	100	311699	

AWG	Screw Size	Qty/ Pkg	Part #
12-10 3-5 mm ²	#8 4 mm	3	312203
		25	312225
		100	312299
	#10 4.8 mm	3	312303
		25	312325
		100	312399
	1/4" 6.4 mm	3	312403
		25	312425
		100	312499
		3	312503
		25	312525
		100	312599
5/16" 7.9 mm	3	312603	
	25	312625	
	100	312699	
8 8 mm ²	#10 4.8 mm	3	321303
		25	321325
		100	321399
	1/4" 6.4 mm	3	321403
		25	321425
		100	321499
	5/16" 7.9 mm	3	321503
		25	321525
		100	321599
	3/8" 9.5 mm	3	321603
		25	321625
		100	321699
1/2" 12.7 mm	3	321703	
	25	321725	
	100	321799	

Heat Shrink Snap Plugs



AWG	Gender	Qty/ Pkg	Part #
22-18 0.3-0.8 mm ²	Female	3	318803
		25	318825
		100	318899
	Male	3	318903
		25	318925
		100	318999
16-14 1-2 mm ²	Female	3	319803
		25	319825
		100	319899
	Male	3	319903
		25	319925
		100	319999

Heat Shrink Spade Terminals

- UL 486A



AWG	Screw Size	Qty/ Pkg	Part #
22-18 0.3-0.8 mm ²	#8 4 mm	3	313203
		25	313225
		100	313299
16-14 1-2 mm ²	#8 4 mm	3	314203
		25	314225
		100	314299
	#10 4.8 mm	3	314303
		25	314325
		100	314399
12-10 3-5 mm ²	#8 4 mm	3	315203
		25	315225
		100	315299
	#10 4.8 mm	3	315303
		25	315325
		100	315399

Related Products



Crimping Tools
pages 49-51



Heat Tools
page 52

Heat Shrink Butt Connectors

- UL 486C



AWG	Qty/ Pkg	Part #
22-18 0.3-0.8 mm ²	3	309003
	25	309025
	100	309099
	500	309002
	3	309103
16-14 1-2 mm ²	25	309125
	100	309199
	500	309102
12-10 3-5 mm ²	3	309203
	25	309225
	100	309299
	500	309202
	3	309303
8 8 mm ²	25	309325
	500	309302

Heat Shrink Butt Connector Packs

- Reusable jar is clear for easy identification and has a flip lid for ease of use
- Reusable compact case (6.625"L x 3.125"W x 1.375"D) fits easily in most storage areas

AWG	Qty/ Pkg	Pkg	Part #
22-18 0.3-0.8 mm ²	250	jar	309001
16-14 1-2 mm ²	250	jar	309101
12-10 3-5 mm ²	200	jar	309201
Assorted (50) 22-18, (150) 16-14, (50) 12-10 AWG	250	jar	309000
Assorted (25) each	75	case	220011



309000



220011

Heat Shrink Step-Down/Multi-Wire Connectors

- 4:1 shrink ratio tubing to ensure a watertight seal between wires
- Flared barrel with uniform copper wall ensures an easy and proper mechanical crimp
- Crimp indicator on barrel for proper placement of installation tool
- Clear heat shrink tubing ensures crimp accuracy
- Colored stripes on the barrel indicate which crimp die to use, regardless of application

AWG	Tubing Color	Pkg Qty	Part #	Barrel End 1	Barrel End 2
24-22 0.2-0.3 mm ²	Clear tube w/ white dashes □□□□□	3	320003	(1) 24-22 AWG	(1) 22-18 AWG or (2) 24-22 AWG
		25	320025		
22-18 0.3-0.8 mm ²	Clear tube w/ red dashes ■ ■ ■ ■ ■	3	320103	(1) 22-18 AWG	(1) 16-14 AWG or (2) 22-18 AWG
		25	320125		
16-14 1-2 mm ²	Clear tube w/ blue dashes ■ ■ ■ ■ ■	3	320203	(1) 16-14 AWG	(1) 12-10 AWG or (2) 16-14 AWG
		25	320225		
12-10 3-5 mm ²	Clear tube w/ yellow dashes ■ ■ ■ ■ ■	3	320303	(1) 12-10 AWG	(1) 8 AWG or (2) 12-10 AWG
		25	320325		

Kit

AWG	Qty/ Pkg	Pkg	Part #
Assorted (5) 24-22 AWG, (10) 22-18 AWG, (10) 16-14 AWG, (5) 12-10 AWG	30	jar	320000



320000

16-14 AWG Step-Down Connector Example

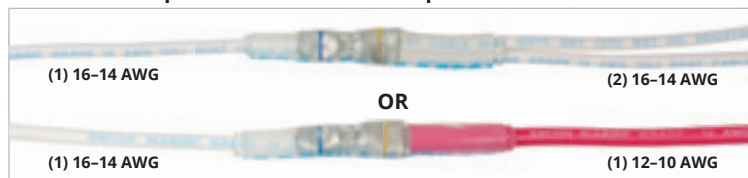

Related Products



Crimping Tools pages 49-51



Heat Tools page 52

Heat Shrink Disconnects



AWG	Tab Size	Gender	Qty/ Pkg	Part #
22-18 0.3-0.8 mm ²	.110	Female	100	326899
	.187	Female	100	336899
			3	316803
	.250	Female	25	316825
			100	316899
			3	316903
16-14 1-2 mm ²	.250	Male	25	316925
			100	316999
	.110	Female	100	327899
	.187	Female	100	337899
			3	317803
			25	317825
12-10 3-5 mm ²			100	317899
			3	317903
	.250	Male	25	317925
			100	317999
			3	320803
			25	320825
12-10 3-5 mm ²			100	320899
			3	320903
	.250	Male	25	320925
			100	320999

Heat Shrink Flag Disconnects

- 90° angle simplifies wire routing and connections
- .250 (6.4mm) tab size



AWG	Gender	Qty/ Pkg	Part #
22-18 0.3-0.8 mm ²	Female	3	356803
		25	356825
16-14 1-2 mm ²	Female	3	357803
		25	357825



SPK1614



SPK2218

Universal Speaker Connector Kits

Ancor's universal speaker connector kits include all the connectors required to install speakers regardless of manufacturer. Heat shrink disconnects provide a sealed connection for the harsh marine environment.

AWG	Qty/ Pkg	Pkg	Part #
22-18 0.3-0.8 mm ²	6	clam	SPK2218
16-14 1-2 mm ²	6	clam	SPK1614

6 pc Kits include:

- (2) .250 tab
- (2) .187 tab
- (2) .110 tab

AWG	Qty/ Pkg	Pkg	Part #
Assorted	90	case	SPKKIT

90 pc Kit includes:

- 22-18 AWG:
(10) .110 tab
(10) .187 tab
(10) .250 tab
- 16-14 AWG:
(20) .110 tab
(20) .187 tab
(20) .250 tab
- Reusable compact case



SPKKIT

Related Products



Crimping Tools
pages 49-51



Heat Tools
page 52

Marine Grade® Terminals

- Ancor's Marine Grade® terminals differ from automotive terminals by being designed for the harsh marine environment
- Tinned copper gives the least electrical resistance but the most corrosion protection
- Nylon insulators are easy to crimp and will not split
- Barrels are designed to tightly grip the wire with the least effort



Nylon Ring Terminals

- Nylon insulated with insulation grip
- Double crimp, funnel entry
- UL 486A

AWG	Screw Size	Qty/ Pkg	Part #
22-18 0.3-0.8 mm ²	#6 3.6 mm	6	230201
		25	210201
	#8 4 mm	6	230202
		25	210202
		100	220202
	#10 4.8 mm	6	230203
		100	220203
	1/4" 6.4 mm	5	230204
		25	210204
	5/16" 7.9 mm	5	230205
		25	210205
	3/8" 9.5 mm	5	230206
25		210206	
16-14 1-2 mm ²	#6 3.6 mm	6	230211
		25	210211
	#8 4 mm	6	230212
		25	210212
		100	220212
	#10 4.8 mm	6	230213
		25	210213
	1/4" 6.4 mm	100	220213
		500	222213
	5/16" 7.9 mm	5	230214
		25	210214
	3/8" 9.5 mm	100	220214
5		230215	
5/16" 7.9 mm	25	210215	
	100	220215	
3/8" 9.5 mm	5	230216	
	25	210216	
1/2" 12.7 mm	100	220216	

AWG	Screw Size	Qty/ Pkg	Part #
12-10 3-5 mm ²	#6 3.6 mm	5	230221
		25	210221
	#8 4 mm	5	230222
		25	210222
		100	220222
	#10 4.8 mm	5	230223
		100	220223
	1/4" 6.4 mm	4	230224
		25	210224
	5/16" 7.9 mm	100	220224
		4	230225
	3/8" 9.5 mm	25	210225
100		220225	
1/2" 12.7 mm	4	230226	
	25	210226	
8 8 mm ²	#10 4.8 mm	100	220226
		3	230227
25		210227	
2	230233		
	1/4" 6.4 mm	25	210233
100		222233	
5/16" 7.9 mm	2	230234	
	25	210234	
100	222234		
	2	230235	
5/16" 7.9 mm	25	210235	
	100	222235	
2	230236		
	3/8" 9.5 mm	25	210236
100		222236	
1/2" 12.7 mm	1	230237	
	25	210237	

AWG	Screw Size	Qty/ Pkg	Part #
6 13 mm ²	#10 4.8 mm	1	230243
		25	210243
	1/4" 6.4 mm	1	230244
		25	210244
	5/16" 7.9 mm	1	230245
		25	210245
	3/8" 9.5 mm	1	230246
		25	210246
	1/2" 12.7 mm	1	230247
		25	210247

Related Products



Crimping Tools
pages 49-51

Nylon Flanged Spades

- Nylon insulated with insulation grip
- Double crimp, funnel entry
- UL 486A



AWG	Screw Size	Qty/ Pkg	Part #
22-18 0.3-0.8 mm ²	#6 3.6 mm	6	230301
		25	210301
	#8 4 mm	6	230302
		25	210302
	#10 4.8 mm	6	230303
		25	210303
16-14 1-2 mm ²	#6 3.6 mm	6	230311
		25	210311
	#8 4 mm	6	230312
		25	210312
	#10 4.8 mm	6	230313
		100	220313
12-10 3-5 mm ²	#8 4 mm	5	230322
		25	210322
	#10 4.8 mm	5	230323
		100	220323

Nylon Single Crimp Butt Connectors

- Nylon insulated seamless
- UL 486C



AWG	Qty/ Pkg	Part #
22-18 0.3-0.8 mm ²	7	230100
	25	210100
	100	220100
	500	222100
16-14 1-2 mm ²	7	230110
	25	210110
	100	220110
12-10 3-5 mm ²	5	230120
	25	210120
	100	220120

Nylon Double Crimp Butt Connectors

- Nylon insulated with insulation grip
- Funnel entry
- UL 486C



AWG	Qty/ Pkg	Part #
22-18 0.3-0.8 mm ²	3	230161
	25	210161
	100	220161
	500	222161
16-14 1-2 mm ²	3	230162
	25	210162
	100	220162
12-10 3-5 mm ²	2	230163
	25	210163
	100	220163

Nylon Flag Disconnects

- .250 (6.4 mm) tab size
- Nylon insulated with insulation grip



AWG	Gender	Qty/ Pkg	Part #
22-18 0.3-0.8 mm ²	Female	4	231601
		25	211601
16-14 1-2 mm ²	Female	4	231611
		25	211611
12-10 3-5 mm ²	Female	3	231621
		25	211621

Nylon Fully Insulated Disconnects

- .250 (6.4 mm) tab size
- Nylon insulated with insulation grip
- Double crimp, funnel entry
- UL 310



AWG	Gender	Qty/ Pkg	Part #
22-18 0.3-0.8 mm ²	Female	4	231408
		25	211408
		100	221408
	Male	4	231409
		25	211409
		100	221409
16-14 1-2 mm ²	Female	4	231418
		25	211418
		100	221418
	Male	4	231419
		25	211419
		100	221419
12-10 3-5 mm ²	Female	3	231428
		25	211428
		100	221428
	Male	3	231429
		25	211429
		100	221429

Nylon Disconnects

- .250 (6.4 mm) tab size
- Nylon insulated with insulation grip
- Double crimp, funnel entry
- UL 310



AWG	Gender	Qty/ Pkg	Part #
22-18 0.3-0.8 mm ²	Female	4	230808
		25	210808
		100	220808
	Male	4	230809
		25	210809
		100	220809
16-14 1-2 mm ²	Female	4	230818
		25	210818
		100	220818
	Male	4	230819
		25	210819
		100	220819
12-10 3-5 mm ²	Female	4	230828
		25	210828
		100	220828
	Male	4	230829
		25	210829
		100	220829

Nylon Multi-Stack Connectors

- .250 (6.4mm) tab size
- Nylon insulated with insulation grip
- Double crimp, funnel entry
- UL 310



AWG	Qty/ Pkg	Part #
22-18 0.3-0.8 mm ²	3	230602
	25	210602A
	100	220602
16-14 1-2 mm ²	3	230612
	25	210612
	100	220612
12-10 3-5 mm ²	3	230622
	25	210622
	100	220622

Nylon 3-Way Connectors

- Nylon insulated with insulation grip
- Double crimp, funnel entry



AWG	Qty/ Pkg	Part #
16-14 1-2 mm ²	1	230510
	25	210510
12-10 3-5 mm ²	1	230520
	25	210520

Nylon Snap Plugs

- Nylon insulated with insulation grip
- Double crimp, funnel entry



AWG	Gender	Qty/ Pkg	Part #
22-18 0.3-0.8 mm ²	Female	4	230709
		25	210709
	Male	4	230708
		25	210708
16-14 1-2 mm ²	Female	4	230719
		25	210719
	Male	4	230718
		25	210718
		100	220718

Vinyl Step Down Butt Connectors

- Vinyl insulated
- UL 486C



AWG	Qty/ Pkg	Part #
16-14 to 22-18 1-2 to 0.3-0.8 mm ²	3	230164
	25	210164
12-10 to 16-14 3-5 to 1-2 mm ²	3	230165
	25	210165
8 to 12-10 8 to 3-5 mm ²	3	230166
	25	210166

Vinyl Butt Connectors

- Vinyl insulated
- UL 486C



AWG	Qty/ Pkg	Part #
8 8 mm ²	2	230130
	25	210130
6 13 mm ²	1	230140
	25	210140
4 21 mm ²	1	230150
	25	210150

Double Male-Female Adapter

- .250 (6.4mm) tab size



Qty/ Pkg	Part #
5	230613
25	210613

Related Products



Crimping Tools
pages 49-51

Tinned Copper Lugs

- Ancor Marine Grade® lugs are manufactured from heavy-duty annealed tinned copper, providing for maximum current flow
- 100% tin plated copper resists corrosion from salt and moisture
- Seamless barrel design allows for maximum strength when crimped
- Closed end design seals out moisture so cables stay dry and corrosion free
- UL 486A



AWG	Screw Size	Qty/ Pkg	Part #
8 8 mm ²	#10 4.8 mm	2	252233
		25	242233
		100	244233
	1/4" 6.4 mm	2	252234
		25	242234
		100	244234
	5/16" 7.9 mm	2	252235
		25	242235
		100	244235
	3/8" 9.5 mm	2	252236
		25	242236
		100	244236
1/2" 12.7 mm	2	252237	
	10	242237	
	6 13 mm ²	#10 4.8 mm	2
25			242243
100			244243
1/4" 6.4 mm		2	252244
		25	242244
		100	244244
5/16" 7.9 mm		2	252245
		25	242245
		100	244245
3/8" 9.5 mm		2	252246
		25	242246
		100	244246
1/2" 12.7 mm	2	252247	
	10	242247	
	5/16" & 3/8" 7.9 & 9.5 mm	1/1	252241

AWG	Screw Size	Qty/ Pkg	Part #
4 21 mm ²	#10 4.8 mm	2	252253
		25	242253
		100	244253
	1/4" 6.4 mm	2	252254
		25	242254
		100	244254
	5/16" 7.9 mm	2	252255
		25	242255
		100	244255
	3/8" 9.5 mm	2	252256
		25	242256
		100	244256
1/2" 12.7 mm	2	252257	
	10	242257	
	5/16" & 3/8" 7.9 & 9.5 mm	1/1	252251
1/4" 6.4 mm		2	252264
		25	242264
	100	244264	
5/16" 7.9 mm	2	252265	
	25	242265	
	100	244265	
2 34 mm ²	3/8" 9.5 mm	2	252266
		25	242266
		100	244266
1/2" 12.7 mm	2	252267	
	10	242267	
	5/16" & 3/8" 7.9 & 9.5 mm	1/1	252261
1/4" 6.4 mm		2	252274
		25	242274
	100	244274	
5/16" 7.9 mm	2	252275	
	25	242275	
	100	244275	
1 42 mm ²	3/8" 9.5 mm	2	252276
		25	242276
		100	244276
1/2" 12.7 mm	2	252277	
	10	242277	

AWG	Screw Size	Qty/ Pkg	Part #	
1/0 53 mm ²	1/4" 6.4 mm	2	252284	
		25	242284	
		100	244284	
	5/16" 7.9 mm	2	252285	
		25	242285	
		100	244285	
	3/8" 9.5 mm	2	252286	
		25	242286	
		100	244286	
	1/2" 12.7 mm	2	252287	
		10	242287	
		2/0 68 mm ²	1/4" 6.4 mm	2
25	242294			
100	244294			
5/16" 7.9 mm	2		252295	
	25		242295	
	100		244295	
3/8" 9.5 mm	2		252296	
	25		242296	
	100		244296	
1/2" 12.7 mm	2		252297	
	10		242297	
	3/0 85 mm ²		5/16" 7.9 mm	2
25		242715		
100		244715		
3/8" 9.5 mm		2	252716	
		25	242716	
		100	244716	
1/2" 12.7 mm		2	252717	
		10	242717	
		4/0 107 mm ²	5/16" 7.9 mm	2
10				242725
100				244725
3/8" 9.5 mm			2	252726
	10		242726	
	100		244726	
1/2" 12.7 mm	2		252727	
	10		242727	

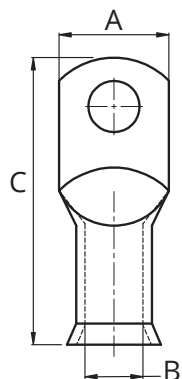

Lug Dimensions

AWG	A	B	C
8	0.465"	0.190"	1.313"
6	0.540"	0.232"	1.512"
4	0.545"	0.280"	1.606"
2	0.650"	0.336"	1.622"-1.772"
1	0.645"	0.360"	1.718"-1.845"
1/0	0.725"	0.410"	1.845"

AWG	A	B	C
2/0	0.825"	0.460"	2.236"-2.268"
3/0	0.910"	0.510"	2.323"
4/0	1.015"	0.560"	2.563"

Related Products



Crimping Tools
pages 49-51



90° Tinned Copper Lugs

90° bend for ease of wire routing

AWG	Screw Size		Qty/ Pkg	Part #
6 13 mm ²	5/16"	7.9 mm	2	262245
	3/8"	9.5 mm	2	262246
4 21 mm ²	5/16"	7.9 mm	2	262255
	3/8"	9.5 mm	2	262256
2 34 mm ²	5/16"	7.9 mm	2	262265
	3/8"	9.5 mm	2	262266
1 42 mm ²	5/16"	7.9 mm	2	262275
	3/8"	9.5 mm	2	262276
1/0 53 mm ²	5/16"	7.9 mm	2	262285
	3/8"	9.5 mm	2	262286
2/0 68 mm ²	5/16"	7.9 mm	2	262295
	3/8"	9.5 mm	2	262296
3/0 85 mm ²	5/16"	7.9 mm	2	262715
	3/8"	9.5 mm	2	262716
4/0 107 mm ²	5/16"	7.9 mm	2	262725
	3/8"	9.5 mm	2	262726



Heavy-duty Butt Connectors

100% Tinned Copper

AWG		Qty/ Pkg	Part #
8	8 mm ²	2	252130
		25	242130
6	13 mm ²	2	252140
		25	242140
4	21 mm ²	2	252150
		25	242150
2	34 mm ²	2	252160
		25	242160
1	42 mm ²	2	252170
		25	242170
1/0	53 mm ²	2	252180
		25	242180
2/0	68 mm ²	2	252190
		25	242190



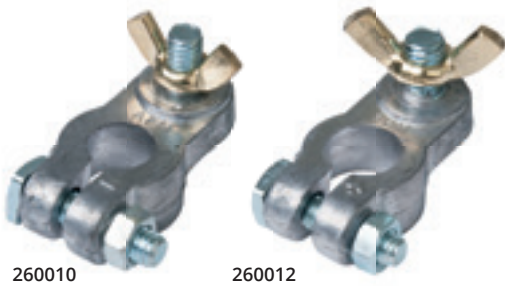

Tinned Brass Battery Terminals

Description	Positive/ Negative	Stud Size	Qty/ Pkg	Part #
Wing Nut	Negative	5/16" (8 mm)	1	260010
Style Yellow Brass Nut	Positive	3/8" (10 mm)	1	260012
	Pos/Neg	5/16" & 3/8" (8 & 10 mm)	1/1	260322

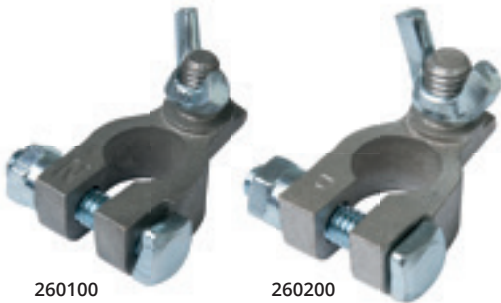

Lead Battery Terminals

Description	Positive/ Negative	Stud Size	Qty/ Pkg	Part #
Wing Nut	Negative	5/16" (8 mm)	1	260100
Style Yellow Brass Nut	Positive	3/8" (10 mm)	1	260200
	Pos/Neg	5/16" & 3/8" (8 & 10 mm)	1/1	260325



Battery Terminal Boots

Description	Size	Color	Qty/ Pkg	Part #
Wing Nut Style	4 & 2 (19 & 32 mm ²)	Black/Red	1/1	260350
Right Angle	8-2 (8-32 mm ²)	Red	1	260381





Battery Clips

Color	Size	Qty/ Pkg	Part #
Red/Black	10A	1/1	260505



Battery Terminal Cleaner

- High impact construction
- Wide, easy grip
- Excellent for hard-to-reach batteries

Part # 700103



Dielectric Silicone Compound

- Fights oxidation to improve conductivity
- Penetrates aluminum oxide to maintain current paths
- Temperature rated at 40° to 500°F / 4°C to 260°C
- 1/3 oz tube

Part # 700115

WIRE MANAGEMENT

Adhesive Lined Heat Shrink Tubing



36

Ancor uses crosslinked polyolefin material for its superior strength and burn resistance. A heat activated adhesive lining creates an impervious seal and provides strain relief.

Repair & Electrical Tape



38

A wide range of repair tape and electrical tape in multiple colors.

Cable Ties



39

Ancor offers a wide variety of materials, sizes and styles including the innovative Self-Cutting Cable Tie which is now available in a mounting version.

Wire Seals



44

Overlapping clamping spines allow for superior pull-out resistance and protection. Strain relief fittings are resistant to salt water, acids, oil, and are not corrosive for marine applications.



WIRE MANAGEMENT

Cable Clamps



43

Stainless steel and Nylon cable clamps are corrosion resistant for marine applications. They absorb shock and vibrations; reducing unwanted noise.

Grommets



44

Provides abrasion resistance for wires passing through panel holes. Flexible construction makes installation simple.

Split Loom & Spiral Wrap



44

Allows flexible routing of cable harnesses and provides abrasion resistance for wire and cable.

Wire Management Kits



45

Ancor offers a wide variety of preassembled kits for all of your wire management projects.

Wire management is integral in making sure that wires and connections are kept organized and protected per ABYC

Adhesive Lined Heat Shrink Tubing (ALT)

- Cross Linked polyolefin tubing is much stronger than PVC tubing and will not burn like PVC
- Heat activated adhesive lining provides impervious seal to salt water, oil, acids, and sunlight as well as providing strain relief
- Highest shrink ratio - shrinks to 1/3 original size
- Shrinks at 257°F / 125°C
- Operating temperature range of -40°F to 230°F / -40°C to 110°C



Wire Range	ALT Dia	Color	Length	Qty/ Pkg	Part #	
<18 AWG <0.8 mm ²	<1/8" <3.2 mm	Black	3" 7.6 cm	3	301103	
			6" 15.2 cm	10	301106	
			12" 30.5 cm	10	301124	
			48" 122 cm	1	301148	
20-12 AWG 0.5-3 mm ²	3/16" 4.8 mm	Black	3" 7.6 cm	3	302103	
			6" 15.2 cm	10	302106	
			12" 30.5 cm	10	302124	
			48" 122 cm	1	302148	
		Red	3" 7.6 cm	3	302603	
			6" 15.2 cm	10	302606	
			12" 30.5 cm	10	302624	
			48" 122 cm	1	302648	
16-10 AWG 1-5 mm ²	1/4" 6.4 mm	Black	3" 7.6 cm	3	303103	
			6" 15.2 cm	10	303106	
			12" 30.5 cm	10	303124	
			48" 122 cm	1	303148	
		Black/Red	3" 7.6 cm	1/1	303602	
			Red	3" 7.6 cm	3	303603
				6" 15.2 cm	5	303606
				12" 30.5 cm	10	303624
12-8 AWG 3-8 mm ²	3/8" 9.5 mm	Black	3" 7.6 cm	3	304103	
			6" 15.2 cm	5	304106	
			12" 30.5 cm	5	304124	
			48" 122 cm	1	304148	
		Black/Red	3" 7.6 cm	1/1	304602	
			Red	3" 7.6 cm	3	304603
				6" 15.2 cm	5	304606
				12" 30.5 cm	5	304624
8-4 AWG 8-19 mm ²	1/2" 12.7 mm	Black	3" 7.6 cm	3	305103	
			6" 15.2 cm	5	305106	
			12" 30.5 cm	5	305124	
			48" 122 cm	1	305148	
		Black/Red	3" 7.6 cm	1/1	305602	
			Red	3" 7.6 cm	3	305603
				6" 15.2 cm	5	305606
				12" 30.5 cm	5	305624
			48" 122 cm	1	305648	

Wire Range	ALT Dia	Color	Length	Qty/ Pkg	Part #
		Black	3" 7.6 cm	3	306103
			6" 15.2 cm	4	306106
			12" 30.5 cm	4	306124
			48" 122 cm	1	306148
8-2/0 AWG 13-62 mm ²	3/4" 19 mm	Black/Red	3" 7.6 cm	1/1	306602
			3" 7.6 cm	3	306603
		Red	6" 15.2 cm	4	306606
			12" 30.5 cm	4	306624
			48" 122 cm	1	306648
		Yellow	3" 7.6 cm	3	306903
			6" 15.2 cm	4	306906
			12" 30.5 cm	4	306924
48" 122 cm	1		306948		
		Black	3" 7.6 cm	3	307103
			6" 15.2 cm	3	307106
			12" 30.5 cm	3	307124
			48" 122 cm	1	307148
		Black/Red	3" 7.6 cm	1/1	307602
			3" 7.6 cm	3	307603
		Red	6" 15.2 cm	3	307606
			12" 30.5 cm	3	307624
48" 122 cm	1		307648		
Yellow	3" 7.6 cm		3	307903	
	6" 15.2 cm	4	307906		
	12" 30.5 cm	4	307924		
	48" 122 cm	1	307948		

Kits

Wire Range	ALT Dia	Color	Length	Qty/ Pkg	Part #
20-2/0 AWG .5-62 mm ²	3/16"-3/4" 4.8-19 mm	Black	3" 7.6 cm	8	301503
			6" 15.2 cm	8	301506
12-8 AWG 3-8 mm ²	3/8" 9.5 mm	Assorted (yw, wh, bl, gr, rd)	3" 30.5 cm	5	304503
			6" 122 cm	5	304506
8-2/0 AWG 8-62 mm ²	3/4" 19 mm	Assorted (yw, wh, bl, gr)	3" 7.6 cm	4	306503

Adhesive Lined Tubing Specifications (3:1 ratio)

Size	Shrinks to	Wire Range (AWG)
1/8" 3.2 mm	1/32" 0.8 mm	<18 < 0.8 mm ²
3/16" 4.8 mm	1/16" 1.6 mm	20-12 0.5-3 mm ²
1/4" 6.4 mm	5/64" 2 mm	16-10 1-5 mm ²
3/8" 9.5 mm	1/8" 3.2 mm	12-8 3-8 mm ²
1/2" 12.7 mm	5/32" 4 mm	8-4 8-19 mm ²
3/4" 19 mm	1/4" 6.4 mm	8-2/0 13-62 mm ²
1" 25.4 mm	5/16" 7.9 mm	2-4/0 32-103 mm ²

Related Products



Adhesive Lined Heavy Wall Battery Cable Tubing (BCT)

- 3:1 ratio
- Shrinks at 257°F / 125°C
- UL 224



BCT Dia.	BCT Color	Length	Qty/ Pkg	Part #
3/4" 19 mm	Black	3" 7.6 cm	3	326103
		6" 15.2 cm	3	326106
		12" 30.5 cm	3	326124
		48" 122 cm	1	326148
	Black/Red	3" 7.6 cm	1/1	326202
		3" 7.6 cm	3	326603
		6" 15.2 cm	3	326606
		12" 30.5 cm	3	326624
Red	6" 15.2 cm	3	326624	
	48" 122 cm	1	326648	

BCT Dia.	BCT Color	Length	Qty/ Pkg	Part #
1" 25 mm	Black	3" 7.6 cm	2	327103
		6" 15.2 cm	2	327106
		12" 30.5 cm	2	327124
		48" 122 cm	1	327148
	Black/Red	3" 7.6 cm	1/1	327202
		3" 7.6 cm	2	327603
		6" 15.2 cm	2	327606
		12" 30.5 cm	2	327624
Red	6" 15.2 cm	2	327624	
	48" 122 cm	1	327648	

Adhesive Lined Heavy Wall Tubing Specifications (3:1 ratio)

Size	Shrinks to	Wire Range (AWG)
3/4" 19 mm	1/4" 6 mm	8-2/0 13-62 mm ²
1" 25 mm	3/8" 9 mm	2-4/0 32-103 mm ²



TECH TIP

Properly Shrinking Heat Shrink Tubing

To properly shrink heat shrink tubing, start by selecting a heat source that will apply the appropriate temperature. Heat shrink tubing will state the shrink temperature, while heat tools are rated based on flame temperatures. Once a heat tool is selected, apply heat gradually to avoid shrinking the tubing inconsistently or burning the tubing. Additionally, continually moving the heat source along the length of the tube will reduce the likelihood of burning the tubing during installation.

Related Products



Repair Tape

Repair tape fuses only to itself when applied under tension. No sticky residue remains on wrapped surfaces.

- Operates and remains flexible from -60°F to 500°F / -51°C to 260°C
- Stretches up to 300% its original length with 60 ppi tear strength
- A permanent air and water tight seal
- Excellent UV resistance
- Begins to bond immediately on contact with itself

Color	Length	Part #	Pkg Qty
Black	1"x10'	341010	1/roll
Clear	1"x10'	343010	1/roll
Red	1"x10'	346010	1/roll
White	1"x10'	347010	1/roll

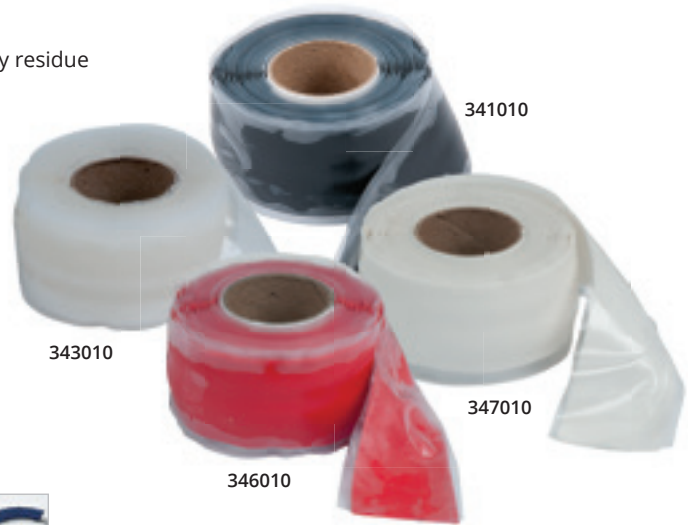

Premium Electrical Tape

Quality electrical tape designed for general purpose electrical applications.

- Made from low-lead 7-mil PVC material
- For applications up to 600V
- Temp rating up to 176°F / 80°C
- UV and moisture resistant

Color	Length	Part #	Pkg Qty
Black	3/4"x66'	331066	1/roll
Red	3/4"x66'	336066	1/roll
White	3/4"x66'	337066	1/roll
Assorted (1 ea of black, red, white, green & yellow)	1/2"x20'	339066	5/roll

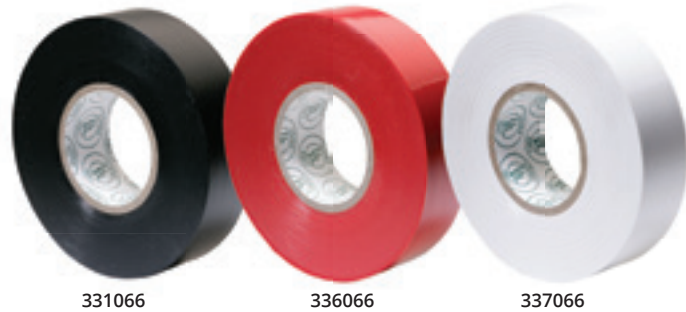

Cable Ties

Ancor offers a wide variety of materials, styles, and sizing options.

With a unique design and high-quality construction, Ancor cable ties provide a great solution for bundling wire, cable, hoses, cords, and countless other applications.



Standard Cable Ties

Length	Color	Unit Qty	Part #		Bundle Dia Max	Tensile Strength
4"	natural	25	199200	yes	13/16"	18 lbs
		100	199201	yes	13/16"	18 lbs
	UVB*	25	199202	yes	13/16"	18 lbs
		100	199203	yes	13/16"	18 lbs
6"	natural	25	199246	yes	1-3/8"	45 lbs
		100	199247	yes	1-3/8"	45 lbs
	UVB*	25	199248	yes	1-3/8"	45 lbs
		100	199249	yes	1-3/8"	45 lbs
8"	natural	25	199204	yes	2"	75 lbs
		100	199205	yes	2"	75 lbs
	UVB*	25	199206	yes	2"	75 lbs
		100	199207	yes	2"	75 lbs
11"	natural	25	199208	yes	3"	75 lbs
		100	199209	yes	3"	75 lbs
	UVB*	25	199210	yes	3"	75 lbs
		100	199211	yes	3"	75 lbs
14"	natural	25	199212	yes	4"	75 lbs
		100	199213	yes	4"	75 lbs
	UVB*	25	199214	yes	4"	75 lbs
		100	199215	yes	4"	75 lbs

* UV Resistant

LEARN MORE
Cable Ties Video



Visit Ancor Products
on YouTube.com



Heavy-duty Cable Ties

Length	Color	Unit Qty	Part #		Bundle Dia Max	Tensile Strength
15"	UVB*	25	199259	yes	4"	175 lbs
		100	199260	yes	4"	175 lbs
17"	natural	10	199216	yes	4-9/10"	175 lbs
	UVB*	10	199217	yes	4-9/10"	175 lbs
24"	natural	10	199218	yes	7"	175 lbs
	UVB*	10	199219	yes	7"	175 lbs
36"	natural	10	199220	yes	10-3/10"	175 lbs
	UVB*	10	199221	yes	10-3/10"	175 lbs
48"	natural	10	199222	yes	14-3/10"	175 lbs
	UVB*	10	199223	yes	14-3/10"	175 lbs

* UV Resistant

Related Products



Diagonal
Cutting Pliers
page 53



Mounting Bases
page 40

Mounting Cable Ties



Length	Color	Unit Qty	Part #		Bundle Dia Max	Tensile Strength
4"	UVB*	25	199245	yes	3/4"	18 lbs
	natural	25	199250	yes	1-3/8"	30 lbs
6"	natural	100	199251	yes	1-3/8"	30 lbs
		25	199252	yes	1-3/8"	30 lbs
	UVB*	100	199253	yes	1-3/8"	30 lbs
		25	199226	yes	2"	50 lbs
8"	natural	100	199227	yes	2"	50 lbs
		25	199228	yes	2"	50 lbs
	UVB*	100	199229	yes	2"	50 lbs
		25	199230	yes	4"	50 lbs
14"	UVB*	25	199257	yes	4"	50 lbs
		100	199258	yes	4"	50 lbs

* UV Resistant

LEARN MORE
Cable Ties Video



Visit Ancor Products
on YouTube.com



199224

199261

199225

Cable Tie Kits

Length	Description	Unit Qty	Part #		Bundle Dia Max	Tensile Strength
8"	assorted colors	24	199224	yes	2"	75 lbs
4", 6", 8"	natural/UVB*	25	199261	yes	13/16", 2"	18, 75 lbs
4", 6", 8"	natural color	500	199225	yes	13/16", 1-1/2", 2"	18, 45, 75 lbs

* UV Resistant

▲ DoubleLock™ on 6" and 8" ties only

Low Profile/Hose Cable Ties



- Reduced head height and contour design conforms to the shape of the wire bundle or hose
- Round design and side tail entry creates a round shape optimal for hoses
- Trimmed tail retracts into cavity leaving a clean, low profile installation
- Tamper-proof pawl is inaccessible after installation
- 50 lbs tensile strength exceeds industry standards



Length	Color	Unit Qty	Part #	Tensile Strength
8"	UVB*	20/bag	199324	50 lbs
		100/bag	199325	50 lbs
11"	UVB*	20/bag	199328	50 lbs
		100/bag	199329	50 lbs

* UV Resistant

Screw Mounting Bases

- #8 bases, 7/10" x 1/2"
- #10 bases, 1" x 5/8"

Description	Unit Qty	Part #
#8 screw, natural	25	199231
	100	199232
#10 screw, natural	25	199262
	100	199263



199262

Adhesive Lined Mounting Bases

- 1" x 1"

Description	Unit Qty	Part #
Natural	5	199233
	25	199234
UVB*	5	199235
	25	199236

* UV Resistant

199233



199235

Self-cutting Cable Ties

Save time and frustration using the latest innovation from Ancor, a self-cutting cable tie. Simply lock and twist to finish the job, with no need for additional tools! Integrated stainless steel blade leaves a clean flush cut, which improves appearance and eliminates the sharp tail while maintaining a tensile strength above industry standards.



Standard Self-cutting Cable Ties

Length	Color	Unit Qty	Part #	Tensile Strength
4"	Natural	50/bag	199333	35 lbs
		500/bag	199334	35 lbs
	UVB*	50/bag	199336	35 lbs
		500/bag	199337	35 lbs
6"	Natural	50/bag	199339	35 lbs
		500/bag	199340	35 lbs
	UVB*	50/bag	199342	35 lbs
		500/bag	199343	35 lbs
8"	Natural	20/bag	199274	50 lbs
		50/bag	199275	50 lbs
		500/bag	199267	50 lbs
	UVB*	20/bag	199276	50 lbs
		50/bag	199277	50 lbs
		500/bag	199264	50 lbs
11"	Natural	20/bag	199278	50 lbs
		50/bag	199279	50 lbs
		500/bag	199268	50 lbs
	UVB*	20/bag	199280	50 lbs
		50/bag	199281	50 lbs
		500/bag	199265	50 lbs
14"	Natural	20/bag	199282	50 lbs
		50/bag	199283	50 lbs
	UVB*	20/bag	199269	50 lbs
		50/bag	199284	50 lbs
		500/bag	199285	50 lbs
		500/bag	199266	50 lbs

* UV Resistant



Heavy-duty Self-cutting Cable Ties

Length	Color	Unit Qty	Part #	Tensile Strength
15"	Natural	20/bag	199320	120 lbs
		100/bag	199321	120 lbs
	UVB*	20/bag	199318	120 lbs
		100/bag	199319	120 lbs
17"	Natural	10/bag	199323	120 lbs
	UVB*	10/bag	199322	120 lbs

* UV Resistant



LEARN MORE
Cable Ties Video



Visit Ancor Products
on YouTube.com



TECH TIP

Wire Bundling Per ABYC Guidelines

ABYC states: "Conductors shall be supported throughout their length or shall be secured at least every 18 inches (455mm) by one of the following methods:

- By means of non-metallic clamps sized to hold the conductors firmly in place. The material shall be resistant to oil, gasoline, and water and shall not break or crack within a temperature range of 30°F (-34°C) to 250°F (121°C)

All of Ancor's cable ties are resistant to oil, gasoline, and water and are rated for use within the ABYC specified range.

Related Products



Mounting Bases
page 40

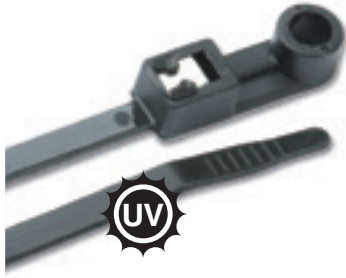

Mounting Self-cutting Cable Ties

Length	Color	Unit Qty	Part #	Tensile Strength
8"	Natural	20/bag	199309	50 lbs
		50/bag	199310	50 lbs
		500/bag	199311	50 lbs
	UVB*	20/bag	199300	50 lbs
		50/bag	199301	50 lbs
		500/bag	199302	50 lbs
11"	Natural	20/bag	199312	50 lbs
		50/bag	199313	50 lbs
		500/bag	199314	50 lbs
	UVB*	20/bag	199303	50 lbs
		50/bag	199304	50 lbs
		500/bag	199305	50 lbs
14"	Natural	20/bag	199315	50 lbs
		50/bag	199316	50 lbs
		500/bag	199317	50 lbs
	UVB*	20/bag	199306	50 lbs
		50/bag	199307	50 lbs
		500/bag	199308	50 lbs

* UV Resistant

TECH TIP

Cable Ties and Moisture

To prevent brittleness and cracking, a certain amount of moisture is incorporated into the Nylon 6/6 material that makes cable ties. Over time, this added moisture can evaporate; especially in dry conditions with low relative humidity. The following steps will help cable ties maintain their pliability and tensile strength:

- Cable ties should be stored in the manufacturer's original packaging until ready for use.
- Partial cable tie bags should be closed or sealed if at all possible. Several drops of water can be added to the bag to provide moisture.
- Cable ties should not be stored in an unheated warehouse or similar location.
- Cable ties inventory should be rotated frequently and used within one year of purchase.

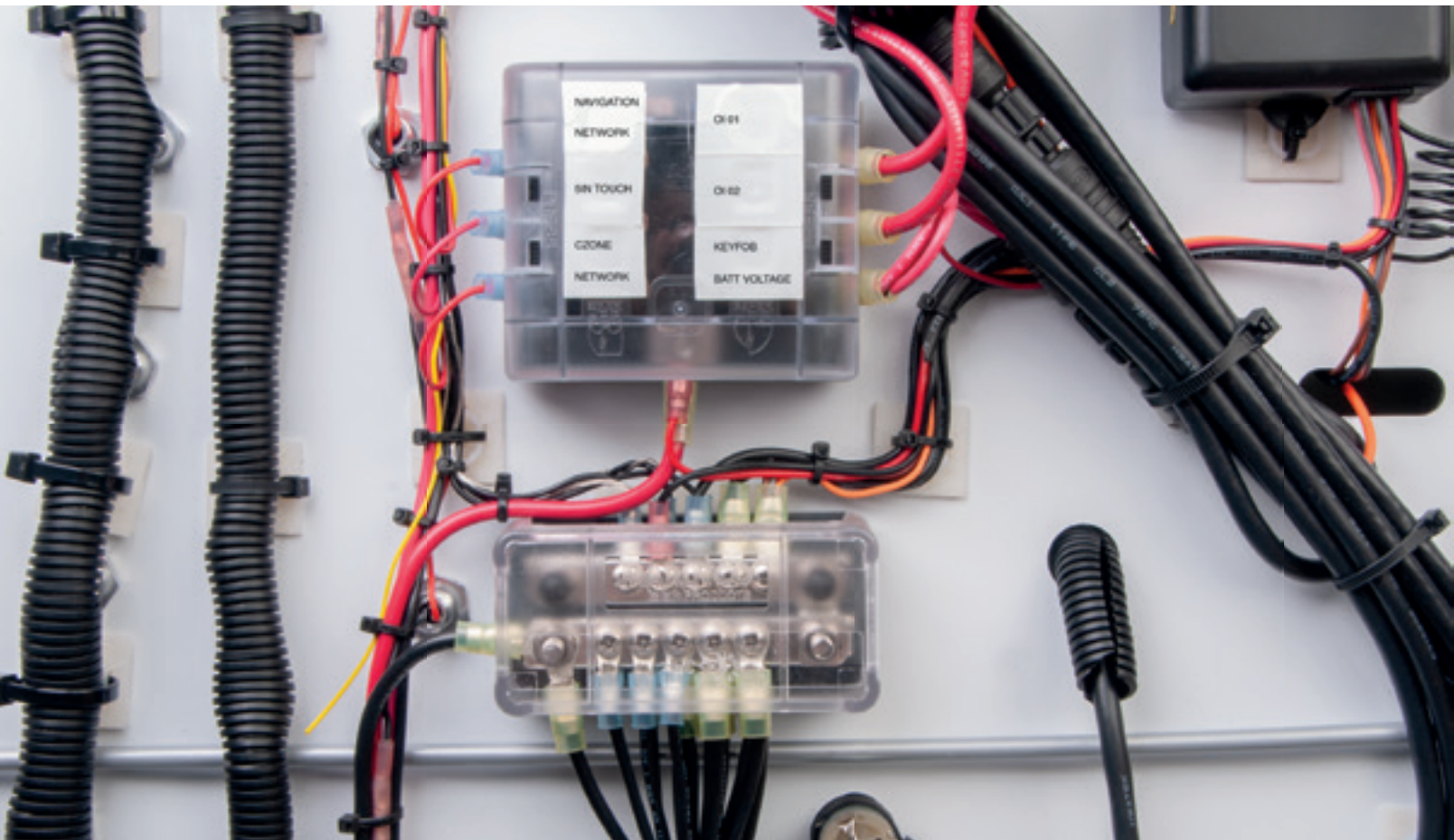

Stainless Steel Cushion Clamps

- Prevents corrosion
- Resistant to oils, acids, salt water
- Temperatures range from -50° to 300°F / -46°C to 149°C
- Absorbs shock and vibration
- Reduces unwanted noise
- 1/4" clearance mounting hole
- 304 stainless steel



Nominal I.D.		Qty/ Pkg	Part #	Band Thickness	Width w/ Cushion	Screw Size
3/16"	5 mm	10	403182	0.04	3/8" 10 mm	#8 4 mm
1/4"	6 mm	10	403252	0.04	3/8" 10 mm	#8 4 mm
5/16"	8 mm	10	403312	0.04	3/8" 10 mm	#8 4 mm
3/8"	10 mm	10	403372	0.04	3/8" 10 mm	#8 4 mm
1/2"	13 mm	10	403502	0.06	1/2" 13 mm	#10 5 mm
9/16"	14 mm	10	403562	0.06	1/2" 13 mm	#10 5 mm
5/8"	16 mm	10	403622	0.06	1/2" 13 mm	#10 5 mm
3/4"	19 mm	10	403752	0.06	1/2" 13 mm	#10 5 mm
7/8"	22 mm	10	403872	0.06	1/2" 13 mm	#10 5 mm
1"	25 mm	10	403892	0.06	1/2" 13 mm	#10 5 mm
1-1/4"	32 mm	10	403902	0.06	1/2" 13 mm	#10 5 mm
1-1/2"	38 mm	10	404152	0.06	1/2" 13 mm	#10 5 mm
1-3/4"	44 mm	10	404172	0.06	1/2" 13 mm	#10 5 mm
2"	51 mm	10	404202	0.06	1/2" 13 mm	#10 5 mm
2-1/2"	64 mm	10	404252	0.06	1/2" 13 mm	#10 5 mm
3"	76 mm	10	404302	0.06	1/2" 13 mm	#10 5 mm
3-1/2"	89 mm	10	404352	0.06	1/2" 13 mm	#10 5 mm

#8 = 0.167" / #10 = 0.203"

TECH TIP

Wire Bundling per ABYC Guidelines

ABYC states: Conductors shall be supported throughout their length or shall be secured at least every 18 inches (455mm) by one of the following methods:

- By means of non-metallic clamps sized to hold the conductors firmly in place. The material shall be resistant to oil, gasoline, and water and shall not break or crack within a temperature range of 30°F to 250°F (-34°C to 121°C)
- By means of metal clamps lined with an insulating material resistant to the effects of oil, gasoline, and water

All of Ancor's cable clamps are resistant to oil, gasoline, and water and are rated for use within the ABYC specified range. Stainless steel cushion clamps are designed to perform within a wider temperature range and provide additional shock, vibration and noise protection compared to nylon cable clamps.

Nylon Cable Clamps

- Made from nylon for maximum strength
- Resistant to solvents, oils, acids and moisture
- Absorbs shock and vibration; reduces unwanted noise



Nominal I.D.	Color	Qty/ Pkg	Part #
1/8"	3 mm	Natural	25 401122
3/16"	5 mm	Natural	25 401182
1/4"	6 mm	Natural	6 401251
		Natural	25 401252
		Natural	100 401255
		UV Black	25 402252
5/16"	7 mm	Natural	25 401312
		UV Black	25 402312
3/8"	9 mm	Natural	25 401372
		UV Black	100 401375
7/16"	11 mm	Natural	25 402372
		Natural	25 401432
1/2"	12 mm	Natural	25 401502
		UV Black	25 402502

Nominal I.D.	Color	Qty/ Pkg	Part #
5/8"	15 mm	Natural	25 401622
	UV Black	25 402622	
3/4"	19 mm	Natural	25 401752
	UV Black	25 402752	
1"	25 mm	Natural	25 401892
	UV Black	25 402892	
1-1/4"	32 mm	Natural	25 401912
1-1/2"	38 mm	Natural	25 401932

Kit

- (9) of each 1/8", 3/16", 1/4", 5/16", 3/8" & 1/2"

Nominal I.D.	Color	Qty/ Pkg	Part #
1/8"-1/2"	3-12 mm	Natural	54 400000

Wire Seals

- Made of Nylon 6/6 flame resistant, self extinguishing Buna-N form seal
- All seals exceed NEMA Type 4X and Type 6 specs
- Overlapping clamping spines allow for superior pull-out protection and resistance
- Strain relief fittings are resistant to salt water, acids, alkalis, alcohol, oils and are non-corrosive for use in the marine environment
- Good underwater to 300 feet / 91.4 m (150 PSIG) provided there is a liquid tight seal between body and housing
- Provide low cost cable entries into panels and junction boxes
- UL 94 v-0



Description	For Use with	Thread Size	Cable Range	Clearance Hole	Body Length	Thread Length	Qty/ Pkg	Part #
Round Cable	18-10 AWG	3/8" NPT	.08"-.24" 2-6 mm	.68"	.87"	.59"	1	764998
Round Cable	10-2 AWG	1/2" NPT	.20"-.47" 5-12 mm	.83"	1.06"	.51"	1	765000
Round or Flat Cable	4-1, 14/3-12/3 & 12/2-10/2 AWG	1/2" NPT	.24"-.55" 6-14 mm	.83"	1.10"	.51"	1	765002
Round Cable	1-3/0 AWG	3/4" NPT	.51"-.71" 13-18 mm	1.05"	1.22"	.51"	1	765004
Round Cable	4/0 AWG	1" NPT	.71"-.98" 18-25 mm	1.35"	1.53"	.75"	1	765006
Flat Cable	14/3-12/3 & 10/2	1/2" NPT	.31"-.56" 8-14 mm	.83"	1.10"	.51"	1	765010
Flat Cable	12/3	3/4" NPT	.31"-.56" 8-14 mm	1.05"	1.22"	.51"	1	765012

Grommets

- Provide instant abrasion resistance to wires passing through panel holes
- Flexible black vinyl makes installation simple

Hole Size	Inside Diameter	Panel Width	Qty/ Pkg	Part #	
3/8"	10 mm	1/4" 6 mm	3/32" 2 mm	5	760375
1/2"	13 mm	3/8" 10 mm	3/32" 2 mm	5	760500
1/4-3/4" Assortment Combo Pack (10 each of 1/4", 5/16", and 3/8", 5 each of 1/2", 11/16", and 3/4")			45	750000	



Spiral Wrap & Split Loom

- Permits flexible routing of cable harnesses
- Provides abrasion protection for wire and cable
- Allows lead outs at any point for greatest ease of installation
- Split loom temperature range is -40°F to 275°F / -40°C to 135°C



Marine Grade® Spiral Wrap

Diameter	Ft/Pkg	Part #	Bundle Range	
			Min	Max
1/4"	6 mm	10'	3/16"	2"
		452251	4.8 mm	5 cm
3/8"	10 mm	10'	5/16"	3"
		100'	452381	8 mm
1/2"	13 mm	10'	25/64"	4"
		100'	452501	10 mm
3/4"	19 mm	10'	3/4"	5"
		100'	452751	19 mm
1"	25 mm	5'	1"	7"
		100'	452900	25 mm

TECH TIP

Wire Bundling per ABYC Guidelines

ABYC states: "Conductors that may be exposed to physical damage shall be protected by loom, conduit, tape, raceways, or other equivalent protection. When AC and DC conductors are run together, the AC conductors shall be sheathed, bundled, or otherwise kept separate from the DC conductors. Loom used to cover conductors shall be self-extinguishing. The base product (or resin) shall be classified as V-2 or better, in accordance with UL 94, Tests For Flammability Of Plastic Materials."



Self-extinguishing Split Loom

Diameter	Ft/Pkg	Part #	
3/8"	10 mm	10'	453382
	100'	453386	
1/2"	13 mm	10'	453502
	100'	453506	
3/4"	19 mm	10'	453752
	100'	453756	
1"	25 mm	5'	453901
	100'	453906	

Wire Management Kits



160 Piece Heat Shrink Connectors and Terminals Kit

Butt Connectors

- (10) 22-18 AWG, (20) 16-14 AWG, (10) 12-10 AWG

Ring Terminals

- (15) 22-18 AWG #10, (15) 16-14 AWG #8, (15) 16-14 AWG #10, (15) 16-14 AWG 1/4", (10) 12-10 AWG #10, (10) 12-10 AWG 1/4", (10) 12-10 AWG 3/8"

Disconnects

- (20) 16-14 AWG female, (10) 16-14 AWG male

Part # 320101



440 Piece Nylon Connectors and Terminals Kit

Butt Connectors

- (40) 22-18 AWG, (75) 16-14 AWG, (40) 12-10 AWG

Ring Terminals

- (25) 22-18 AWG #8, (25) 16-14 AWG #8, (50) 16-14 AWG #10, (25) 12-10 AWG #8, (25) 12-10 AWG #10

Disconnects

- (50) 16-14 AWG fully insulated female, (30) 16-14 AWG fully insulated male, (25) 16-14 AWG female, (30) 16-14 AWG male

Part # 250101



100 Piece Tinned Copper Lug Kit

- (10) 8 AWG, 5/16", (10) 8 AWG, 3/8"
- (10) 6 AWG, 5/16", (10) 6 AWG, 3/8"
- (10) 4 AWG, 5/16", (10) 4 AWG, 3/8"
- (10) 2 AWG, 5/16", (10) 2 AWG, 3/8"
- (5) 1/0 AWG, 5/16", (5) 1/0 AWG, 3/8"
- (5) 2/0 AWG, 5/16", (5) 2/0 AWG, 3/8"

Part # 255101



47 Piece Adhesive Lined Heat Shrink Tubing Kit

Black

- (10) 3/16" x 6"
- (10) 1/4" x 6"
- (10) 3/8" x 6"
- (5) 1/2" x 6"
- (3) 3/4" x 3"
- (3) 1" x 3"

Red

- (3) 3/4" x 3"
- (3) 1" x 3"

Part # 330101



Promotional Storage Rack

Part # P33407

Individual Empty Trays

Part # P33406 6 compartment

Part # P33412 12 compartment



Premium Connector Kit

- Nylon insulated with insulation grip
- Double crimp, funnel entry
- Kit includes assorted butt connectors, ring terminals, spade terminals, and disconnects (18-10 AWG)

Part # 220003 120 pcs

TOOLS & TESTERS

Cut/Strip/Crimp Tools



48

Ancor offers a broad range of wire management and termination tools for all of your wiring projects.

Crimpers



50

Ancor offers other speciality tools to provide users with everything needed for any project.



TOOLS & TESTERS

Pliers and Screwdrivers



53

Insulated pliers and screw drivers for added safety when working on an electrical project.

Heat Tools



52

Ancor offers a range of heat tools, including the new dual setting heat gun, that are perfect for multiple projects from heat shrink tubing to paint stripping.

Digital Multimeters



54

Multimeters to suit any electrical testing requirements.



Every installation requires quality tools and testing devices to ensure quick projects and larger refits can be accomplished accurately and to ABYC standards.



Wire & Cable Cutter

- Steel forged blades easily cut 22 AWG to 2/0 AWG copper wire and cable
- Contoured cushion grips for comfort and ease of use
- Length: 9.25" (23.5 cm)

Part # 703005



Heavy-duty Wire & Cable Cutter

- Steel forged blades easily cut up to 350MCM (2 sizes larger than 4/0 AWG) copper wire and cable
- Strong fiberglass handles with thermoplastic rubber grips for comfort and slip resistance
- Length: 17.5" (44.4 cm)

Part # 703006



Heavy-duty Wire Scissors

- Corrosion resistant stainless steel blades
- Ergonomic overmolded handles for comfort and safety
- Cut wire up to 6 AWG (13 mm²)
- Includes safety holster with belt clip
- Length: 5.9" (15 cm)

Part # 703007



Cut/Strip Tool

- Precision ground cutter and stripping stations
- Strips wire from 24 AWG to 10 AWG (0.5 to 2.6 mm²)
- Length: 6.6" (16.7 cm)

Part # 702008



Cut/Strip/Crimp Tool

- Precision ground cutters and stripping station
- Capacity: Crimps 22 AWG to 10 AWG / 0.3 to 5 mm² insulated and non-insulated terminals, connectors and spark plug terminals in special cavities
- Strips insulation from 22 AWG to 10 AWG / 0.3 to 5 mm² solid and stranded wires
- Cuts (4) 40/2 mm, (6) 32/4 mm, (8) 32/4.8 mm, (10) 32/6.4 mm and 10-24/6.4 mm bolts
- Length: 8.6" (20.3 cm)

Part # 702007

Premium Battery Cable Stripper

- Punctures the cable's insulation, breaks the insulation free and pulls the cut insulation from the wire in one efficient motion
- Strips 8 AWG through 400 MCM cable
- Heavy-duty construction
- Length: 5.3" (13.0 cm)

Part # 703075



Compact Automatic Wire Stripper

- Compact design perfect for use in tight spaces
- Strips without damage or marking of conductors
- Strips and cuts wire from 20 AWG to 10 AWG (0.05-5.0mm²)
- Length: 6.3" (16 cm)

Part # 702031



Automatic Wire Stripper

- Automatically adjusts to different wire sizes
- Strips without damage or marking of conductors, slim jaw for easy access, steel side cutter
- Strips and cuts wire from 24 AWG to 12 AWG / 0.02-5.0mm²
- Wire stop adjusts length of strip from 3/8" to 1/2" (9.5 to 12.7 mm)
- Length: 6.7" (17.0 cm)

Part # 702030



Universal Wire Stripper

- Two different cutting methods to cut either small guage wire or large guage battery cable
- Wire stripping from 20 AWG to 10 AWG (0.05-5.0mm²)
- Battery cable stripping from 8 AWG to 4/0 AWG (8 to 107mm²)
- Length: 5.7" (14.5 cm)

Part # 702032

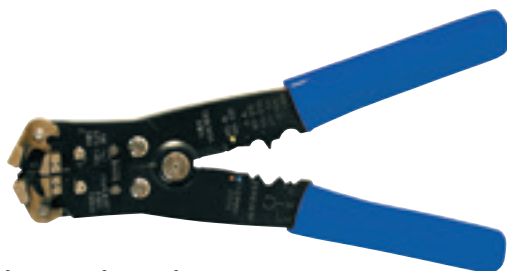

Wire Strip Crimp Tool

- Strips 26 AWG to 10 AWG stranded wire
- Automatic jaw-load wire stripper self-adjusts to strip wire
- Crimps 22 AWG to 10 AWG insulated terminals
- Length: 8.1" (20.6 cm)

Part # 702033



LEARN MORE
Universal Wire
Stripper Video



Visit Ancor Products
on YouTube.com

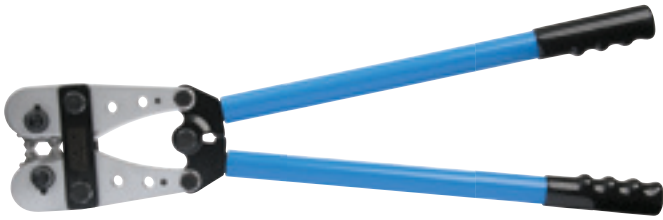

8 to 4/0 AWG Heavy-duty Hex Lug & Terminal Crimper

- Uses revolving dies to create a hex style crimp for 8 AWG to 4/0 AWG
- Length: 24.4" (62 cm)

Part # 703040

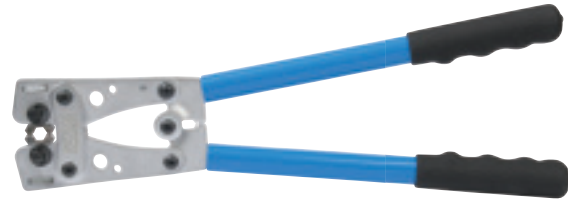

8 to 1/0 AWG Hex Lug & Terminal Crimper

- Uses revolving dies to create a hex style crimp for 8 AWG to 1/0 AWG
- For portable use
- Length: 15.4" (39 cm)

Part # 703050



22 to 8 AWG Single Crimp Ratcheting Crimper

- Ideal for crimping heat shrink terminals
- Can also be used with vinyl and nylon insulated terminals and connectors
- Must be fully closed before tool allows itself to open ensuring a proper crimp
- Includes lever to release jaws mid-cycle in the event of an incorrectly placed terminal
- Ratcheting operation with ergonomic handle to prevent hand fatigue
- 4 color-coded cavities for different wire sizes
- Length: 10.9" (27.6 cm)

Part # 703010



26 to 10 AWG Double Crimp Ratcheting Crimper

- Ideal for crimping nylon and vinyl terminals
- Double crimp mechanism crimps stranding and insulation portion of Ancor connectors in one motion for superior strain relief of vinyl and nylon terminals
- Must be fully closed before tool allows itself to open ensuring a proper crimp
- Includes lever to release jaws mid-cycle in the event of an incorrectly placed terminal
- Ratcheting operation with ergonomic handle to prevent hand fatigue
- 4 color-coded cavities for different wire sizes
- Length: 10.9" (27.6 cm)

Part # 703030

LEARN MORE
Ratcheting Crimp
Tools Video



Visit Ancor Products
on YouTube.com

TECH TIP

Tool Selection per ABYC Guidelines

ABYC recommends that the tool used to crimp connectors be manufactured by the same brand as the connectors themselves. The reason behind this is that the barrel and insulation thickness varies by connector manufacturer. Therefore having a crimping tool designed for specific connectors ensures a secure and safe crimp.



Angled 22 to 8 AWG Single Crimp Ratcheting Crimper

- For crimping heat shrink terminals
- Angled head design is ideal for use in tight spaces
- Self-releasing mechanism ensures a proper crimp
- Ratcheting operation and ergonomic handles prevent fatigue
- Length: 9.5" (24 cm)

Part # 703015



Angled 26 to 10 AWG Double Crimp Ratcheting Crimper

- For crimping nylon and vinyl terminals
- Angled head design is ideal for use in tight spaces
- Self-releasing mechanism ensures a proper crimp
- Ratcheting operation and ergonomic handles prevent fatigue
- Length: 9.5" (24 cm)

Part # 703035

LEARN MORE
Single vs Double
Crimp Video

Visit Ancor Products
on YouTube.com

Flag Terminal Die Sets

- Works with all Ancor ratcheting crimpers; 703010, 703015, 703030, 703035

Part # 703041 22-18 & 16-14 AWG

Part # 703042 12-10 AWG



703041

703042

Mini Fish Tape

- Durable, high-impact housing
- Low-memory 15 ft tape does not curl during extension—perfect for non-conduit situations
- Compact, rugged design can be stored in tool belt or box
- Feed under carpet, behind walls or through panels
- Perfect for short runs, installing speakers, instrument clusters or other common electrical uses

Part # 703112



Mini Pocket Butane Torch

- Piezo electronic ignition system
- Flame temperature up to 2500°F / 1300°C
- Windproof and waterproof flame
- Pocket size allows the unit to fit easily into any tool kit
- Powered by disposable cigarette lighter or refillable butane fuel cell (included)

Part # 703024



Pro Torch

- Up to 90 minutes of time on each filling
- Flame temperature up to 2500°F / 1300°C
- Adjustable flame control
- Compact size with ergonomic grip
- Includes removable solder tip and removable base for added flexibility
- Refillable

Part # 703060



120V Two Setting Heat Gun

- Two settings—Low: 572°F / 300°C, 10 CFM / 17 CMH and High: 1,000°F / 538°C, 17 CFM / 29 CMH (cubic meters per hour)
- 6.5' cord, 120V AC
- Great for heat shrink tubing and connectors, stripping paint and more
- Lightweight, under two pounds
- Stands on end for hands free operation
- Includes three nozzles and carrying case

Part # 703023

Three nozzles for a variety of applications



Carrying case included



Stands on end for hands free operation



Micro Therm Heat Gun

- Features Piezo electronic ignition system, providing flame less heat, safe to use around chemicals or by wire bundles when using deflector
- Powered by refillable cell
- Flame temperature up to 1300°F / 650°C
- Ideal for work in the bilge where open flame should not be used
- Refillable

Part # 702027



7 Pc Insulated Screwdriver Set

- Kit includes:
 - (1) 1/8" x 3" Slotted (1) #0 x 3" Phillips
 - (1) 7/32" x 5" Slotted (1) #1 x 3" Phillips
 - (1) 1/4" x 6" Slotted (1) #2 x 4" Phillips
 - (1) Test probe
- Insulated to 1000V
- Includes convenient storage/carrying case

Part # 711000



6" Long Nose Pliers

- Insulated to 1000V
- Ideal for use in tight spaces
- Chrome Vanadium
- Length: 6" (15.2 cm)

Part # 710010



7" Combination Pliers

- Insulated to 1000V
- Combines both gripping jaws and wire cutter
- Chrome Vanadium
- Length: 7" (17.8 cm)

Part # 710020



6" Bent Nose Pliers

- Insulated to 1000V
- Ideal for use in tight spaces
- Chrome Vanadium
- Length: 6" (15.2 cm)

Part # 710030



6" Diagonal Cutting Pliers

- Insulated to 1000V
- Ergonomic cutter for wire or cable ties
- Chrome Vanadium
- Length: 6" (15.2 cm)

Part # 710040

8 Function Digital Multimeter

- Auto ranging capability allows the meter to automatically determine the resolution based on the application
- Clear LCD display
- Lightweight, ergonomic design
- Comfortable protective cover, with test lead hanging groove
- Loud buzzer sound
- Batteries: two AAA Batteries (not included)
- Continuity ✓, Diode Test ✓

Specifications	Range	Accuracy
DC Voltage (V)	200.0mV, 2000mV/2.000V, 20.00V, 200.0V, 250V	200.0mV, 20.00V, 200.0V, 250V (0.7% + 3) 2000mV/2.000V (0.5% + 2)
AC Voltage (V)	200.0mV, 2000mV/2.000V, 20.00V, 200.0V, 250V	200.0mV, 20.00V (1.0% + 2) 2000mV/2.000V (0.7% + 3) 200.0V, 250V (1.2% + 3)
DC Current (A)	200.0μA, 2000μA, 20.00mA, 200.0mA, 2.000A, 10.00A	200.0μA, 2000μA, 20.00mA, 200.0mA (1.0% + 2) 2.000A, 10.00A (1.2% + 5)
AC Current (A)	200.0μA, 2000μA, 20.00mA, 200.0mA, 2.000A, 10.00A	200.0μA, 2000μA, 20.00mA, 200.0mA (1.2% + 3) 2.000A, 10.00A (1.5% + 5)
Resistance (Ω)	200.0 2000/2.000k, 20.00k, 200.0k, 20.00M, 200.0M	200 (1.0% + 2) 2000/2.000k, 20.00k, 200.0k (0.8% + 2) 20.00M (1.2% + 3) 200.0M (5.0% + 10)
Capacitance (F)	2.000nF, 20.00nF, 200.0nF, 2.000μF, 20.00μF, 200.0μF, 2.000mF	2.000nF (REL Mode: 5.0% + 5) 20.00nF, 200.0nF, 2.000μF, 20.00μF, 200.0μF (4.0% + 8), 2.000mF (10%)
Overload Protection	250V rms	
CAT Rating	CAT II 250V	

703072



5 YEAR WARRANTY   

True RMS 12 Function Digital Multimeter

- Auto ranging capability allows the meter to automatically determine the resolution based on the application
- Clear LCD display
- Comfortable protective cover, with test lead hanging groove
- High voltage warning
- Auto power off functionality to save battery life
- Batteries: two AAA Batteries (not included)
- Continuity ✓, Diode Test ✓, NCV ✓

Specifications	Range	Accuracy
DC Voltage (V)	600.0mV, 6000mV/6.000V, 60.00V, 600.0V	600.0mV, 60.00V, 600.0V (0.7% + 3) 6000mV/6.000V (0.5% + 2)
AC Voltage (V)	600.0mV, 6000mV/6.000V, 60.00V, 600.0V	600.0mV, 60.00V (1.0% + 2) 6000mV/6.000V (0.7% + 3) 600.0V (1.2% + 3)
DC Current (A)	600.0μA, 6000μA, 60.00mA, 600.0mA, 6.000A, 10.00A	600.0μA, 6000μA, 60.00mA, 600.0mA (1.0% + 3) 6.000A, 10.00A (1.2% + 5)
AC Current (A)	600.0μA, 6000μA, 60.00mA, 600.0mA, 6.000A, 10.00A	600μA, 6000μA, 60.00mA, 600.0mA (1.2% + 3) 6.000A, 10.00A (1.5% + 5)
Resistance (Ω)	600.0, 6000/6.000k, 60.00k, 600.0k, 60.00M	600 (1.0% + 2) 6000/6.000k, 60.00k, 600.0k (0.8% + 2) 60.00M (2.0% + 5)
Capacitance (F)	9.999nF, 99.99nF, 999.9nF, 9.999μF, 99.99μF, 999.9μF, 9.999mF	9.999nF (REL Mode: 4.0% + 10) 99.99nF, 999.9nF, 9.999μF, 99.99μF, 999.9μF (4.0% + 5), 9.999mF (10%)
Frequency (Hz)	10.00Hz-1.000MHz	10.00Hz-1.000MHz (0.1% + 5)
Temperature (°F)	-40°F to 1832°F	-40 to 104°F (5%) 104°F to 932°F (1.5% + 5) 932°F to 1832°F (2.5% + 5)
Temperature (°C)	-40°C to 1000°C	-40 to 40°C (4°C) 40°C to 500°C (1.0% + 4) 500°C to 1000°C (2.0% + 4)
Overload Protection	600V rms	
CAT Rating	CAT III 600V	

703073



5 YEAR WARRANTY   

True RMS 12 Function Digital Snap-Around Meter

- Easy to read backlit OLED screen
- Non-contact AC voltage testing
- Provides accurate readings for both pure sine wave and modified sine wave electrical circuits
- Zeroing function
- Flashlight for use in dark compartments
- Includes convenient carrying case
- Batteries: three AAA Batteries (not included)
- Continuity ✓, Diode Test ✓, NCV ✓

Specifications	Range	Accuracy
DC Voltage (V)	600.0mV, 6000mV, 6.000V, 60.00V, 600.0V, 1000V	600.0mV (1.0% + 8) 6000mV/6.000V (0.8% + 1) 60V, 600V (0.8% + 3) 1000V (1.0% + 3)
AC Voltage (V)	6.000V, 60.00V, 600.0V 750V	6.000V, 60.00V, 600.0V (1.2% + 5) 750V (1.5% + 5)
DC Current (A)	60.00A, 600.0A	60.00A, 600.0A (2.5% + 5)
AC Current (A)	60.00A, 600.0A	60.00A, 600.0A (2.5% + 5)
Resistance (Ω)	600.0, 6000/6.000k, 60.00k, 600.0k, 6.000M, 60.00M	600.0, 6.000M (1.2% + 2) 6000/6.000k, 60.00k, 600.0k (1.0% + 2) 60.00M (1.5% + 5)
Capacitance (F)	60.00nF, 600.0nF, 6.000μF, 60.00μF, 600.0μF, 6.000mF	60.00nF (4.0% + 25) 600.0nF, 6.000μF, 60.00μF, 600.0μF (4.0% + 5) 6.000mF (10%)
Frequency (Hz)	10.00Hz–1.000MHz	10.00Hz–1.000MHz (0.1% + 4)
Temperature (°F)	-40°F to 1832°F	-40°F to 104°F (3.0% + 10) 104°F to 752°F (3.0% + 10) 752°F to 1832°F (2.0% + 10)
Temperature (°C)	-40°C to 1000°C	-40°C to 40°C (3.0% + 5) 40°C to 400°C (3.0% + 5) 400°C to 1000°C (2.0% + 5)
Overload Protection	1000V DC, 750V AC	
CAT Rating	CAT II 1000V, CAT III 600V	

703079



5 YEAR WARRANTY    



TECH TIP

Measuring AC Current

Typically, a standard multimeter is accurate and reliable when measuring DC current. However, the same cannot be said for AC current. This is because AC current travels in the shape of a true or modified sine wave. When current is non-linear, you'll need a meter that can measure the current with the highest level of accuracy. This is achievable through Root Mean Square (RMS). True RMS is an advanced calculation used by digital multimeters which provides accurate values of AC levels. It doesn't matter if the current is distorted. A true RMS multimeter adjusts itself accordingly to deliver accurate results.

DISPLAYS

Heat Shrink Terminal, Connector & Tubing Displays

58

Ancor's most popular consumer packages of adhesive lined heat shrink tubing, heat shrink terminals, and butt connectors.



DISPLAYS

Marine Grade® Tinned Wire Displays



59

This compact counter top display consists of 60 spools of the 12 most common wire sizes and colors. All wire is Premium UL 1426 Tinned Copper Primary Wire.

Tinned Copper Lug Displays



58

24 sizes of heavy-duty tinned copper lugs, 8 AWG to 4/0. Includes combo packs, battery terminals, and heavy-duty lug crimper.

NMEA 2000 Display



60

Simple drop in NMEA 2000 store set. Kit includes everything needed to build a new NMEA network or expand on an existing network.

Anchor product displays can quickly and effectively increase sales by providing an assortment of products to customers in an easy to shop layout



Heat Shrink Terminal, Connector & Tubing Display

Part # DR2230

Part #	Description	Qty/ Pkg	# of Pkgs
309003	22-18 AWG Heat Shrink Butt	3	3
309103	16-14 AWG Heat Shrink Butt	3	3
309125	16-14 AWG Heat Shrink Butt	25	3
309203	12-10 AWG Heat Shrink Butt	3	3
300000	22-10 AWG Heat Shrink Butt	10	3
310203	22-18 #8 Heat Shrink Ring	3	3
310303	22-18 #10 Heat Shrink Ring	3	3
320003	24-22/24-18 Step-Down, Heat Shrink Butt	3	3
320103	22-18/22-14 Step-Down, Heat Shrink Butt	3	3
320203	16-14/16-10 Step-Down, Heat Shrink Butt	3	3
320303	12-10/12-8 Step-Down, Heat Shrink Butt	3	3
311203	16-14 #8 Heat Shrink Ring	3	3
311303	16-14 #10 Heat Shrink Ring	3	3
311503	16-14 5/16" Heat Shrink Ring	3	3
311603	16-14 3/8" Heat Shrink Ring	3	3
SPK2218	22-18 AWG Heat Shrink, Speaker Connector Kit	6	3
SPK1614	16-14 AWG Heat Shrink, Speaker Connector Kit	6	3
312203	12-10 #8 Heat Shrink Ring	3	3
312303	12-10 #10 Heat Shrink Ring	3	3
312503	12-10 5/16" Heat Shrink Ring	3	3
312603	12-10 3/8" Heat Shrink Ring	3	3
304503	3/8" x 3" Heat Shrink Tubing Assortment	5	3
301103	1/8" x 3" Heat Shrink Tubing, Black	3	3
302103	3/16" x 3" Heat Shrink Tubing, Black	3	3
303103	1/4" x 3" Heat Shrink Tubing, Black	3	3
304103	3/8" x 3" Heat Shrink Tubing, Black	3	3
305103	1/2" x 3" Heat Shrink Tubing, Black	3	3
306103	3/4" x 3" Heat Shrink Tubing, Black	3	3
301503	3/16"-3/4" x 3" Heat Shrink Tubing Asst, Black	8	3



Tinned Copper Lug Display

Part # DR2425

Part #	Description	Qty/ Pkg	# of Pkgs
252233	#8 #10 Tinned Lug	2	2
252234	#8 1/4" Tinned Lug	2	2
252235	#8 5/16" Tinned Lug	2	2
252236	#8 3/8" Tinned Lug	2	2
252243	#6 #10 Tinned Lug	2	2
252244	#6 1/4" Tinned Lug	2	2
252245	#6 5/16" Tinned Lug	2	2
252246	#6 3/8" Tinned Lug	2	2
252254	#4 1/4" Tinned Lug	2	2
252255	#4 5/16" Tinned Lug	2	2
252256	#4 3/8" Tinned Lug	2	2
252265	#2 5/16" Tinned Lug	2	2
252266	#2 3/8" Tinned Lug	2	2
252275	#1 5/16" Tinned Lug	2	2
252276	#1 3/8" Tinned Lug	2	2
252285	#1/0 5/16" Tinned Lug	2	2
252286	#1/0 3/8" Tinned Lug	2	2
252295	#2/0 5/16" Tinned Lug	2	2
252296	#2/0 3/8" Tinned Lug	2	2
252726	#4/0 3/8" Tinned Lug	1/1	2
252241	#6 5/16" & 3/8" Combo Pack	1/1	2
252251	#4 5/16" & 3/8" Combo Pack	1/1	2
252261	#2 5/16" & 3/8" Combo Pack	1/1	2
260325	Battery Terminal, Wing Nut, 5/16" & 3/8" Combo	1/1	2

All displays come with matching header, hooks, planogram and re-order tags.



Marine Grade® Tinned Wire Display

Part # DR2218

Part #	Description	# of Pkgs
180003	35' 18 AWG (0.8mm ²), Black	2
180803	35' 18 AWG (0.8mm ²), Red	2
182003	25' 16 AWG (1mm ²), Black	2
182803	25' 16 AWG (1mm ²), Red	2
182303	25' 16 AWG (1mm ²), Green	2
182903	25' 16 AWG (1mm ²), White	2
184003	18' 14 AWG (2mm ²), Black	2
184803	18' 14 AWG (2mm ²), Red	2
184303	18' 14 AWG (2mm ²), Green	2
184903	18' 14 AWG (2mm ²), White	2
186003	12' 12 AWG (3mm ²), Black	2
186803	12' 12 AWG (3mm ²), Red	2

All displays come with matching header, hooks, planogram and re-order tags.





NMEA 2000 Planogram Assortment

Part # 270400

Simple drop in NMEA 2000 store set. Kit includes everything needed to build a new NMEA network or expand on an existing network.

Part #	Description	# of Pkgs
270000	NMEA 2000 Power Cable With Tee - 1m	1
270010	NMEA 2000 Backbone Cable - 10m	1
270101	NMEA 2000 Single Tee Connector	1
270105	NMEA 2000 Female Terminator	1
270106	NMEA 2000 Male Terminator	1
270109	NMEA 2000 Field Servicable Connector, Female	1
270110	NMEA 2000 Field Servicable Connector, Male	1
270201	NMEA 2000 Single Device Starter Kit	1
270301	NMEA 2000 Drop Cable - 1 Meter	1
270305	NMEA 2000 Drop Cable - 5 Meter	1

All displays come with matching header and planogram.

Countertop Display Replacement Headers



Part # ANCSHRINK



Part # ANCTERM



Part # ANCWIRE



Part # ANCLUG



Part # ANCNMEA

Wire & Cable Technical Data

Using the wrong type of wire can cost you more in the long run. Insist on Marine Grade® Boat Cable by Ancor. It is UL approved for the corrosive marine environment and charter boat service. Marine Grade Boat Cable is specially designed to exceed all test standards for cold bend, moisture and oil resistance, heat shock and flammability. This ensures the safest, easiest to install, longest lasting and ultimately the least expensive electrical system you can buy. Only Ancor offers a complete line of Marine Grade Boat Cable for every need.

“Can I use ‘regular wire’ for my boat?” The answer to this common question is a qualified "yes." However, caution is advised and the installer must understand the circumstances in which SAE (Society of Automotive Engineering) J378, J1127 or J1128 wire can, and can not be used. Keep in mind that these wires are designed for "surface vehicles," not for the special

requirements of the marine industry. Even if tinned copper, they should not be run in bilge spaces or other areas subject to moisture from spray or dripping. They should not be run in engines spaces, unless marked "oil resistant" and "75°C". They should not be used in applications where subjected to vibration or frequent flexing and must never be used for 110 volt applications. For safety, use only wire which is marked with size, type and temperature rating.

Most importantly, SAE wire is up to 12% smaller than AWG Boat Cable which means that, in many applications, larger gauge wire must be used to stay within the voltage drop limits recommended by experts. The wire charts found in "Chapman's Piloting" and other publications are all for "AWG" wire like Ancor, not "SAE" type wire.

ABYC Recommended Usages

Color	Item	Use
Red	DC Positive Conductor	Positive Mains
Black or Yellow	DC Negative Conductor	Return, Negative Mains
Green or Green w/ Yellow Stripe	DC Grounding Conductor	Bonding System Bonding Wires (if insulated)
Light Blue	Oil Pressure	Oil Pressure Sender to Gauge
Dark Blue	Cabin & Instrument Lights	Fuse or Switch to Lights
Brown	Generator Armature	Generator Armature to Regulator
	Alternator Charge Light	Generator Terminal/Alternator Auxiliary Terminal to Light to Regulator
	Pumps	Fuse or Switch to Pumps
Grey	Navigation Lights	Fuse or Switch to Lights
	Tachometer	Tachometer Sender to Gauge
Orange	Accessory Feed	Ammeter to Alternator or Generator Output and Accessory Fuses or Switches
	Common Feed	Distribution Panel to Accessory Switch
Pink	Fuel Gauge	Fuel Gauge Sender to Gauge
Purple	Ignition	Ignition Switch to Coil & Electrical Instruments
	Instrument Feed	Distribution Panel to Electric Instruments
Brown w/ Yellow Stripe	Bilge Blowers	Fuse or Switch to Blower
Yellow w/ Red Stripe	Starting Circuit	Starting Switch to Solenoid
Tan	Water Temperature	Water Temperature Sender to Gauge
Green/Stripe (G/x) (except G/Y)	Tilt Down and/or Trim In	Tilt and/or Trim Circuits
Blue/Stripe (Bl/x)	Tilt Up and/or Trim Out	Tilt and/or Trim Circuits

Conductors Sized (AWG) for 3% Voltage Drop

3% Voltage Drop at 12 Volts

Use 3% voltage drop for any "critical application" affecting the safety of the vessel or its passengers: bilge pumps, navigation lights, electronics, etc....

Length (feet): Determined by measuring the length of the conductor from the positive (+) power source connection to the electrical device and back to the negative (-) power source connection. Note that the power source connection may be either the battery, panelboard or switchboard.

Current (amps): Determined by adding the total amps on a circuit.

Conductor sizes not covered in the following tables may be calculated by using the following formula:

$$CM = \frac{K \times I \times L}{E}$$

After calculating the Circular Mil Area (CM), use the temperature rating chart to determine the proper conductor size (National Fire Protection Agency and Coast Guard require that the next larger conductor be used when the calculated CM area falls between the two conductor sizes).

CM = Circular Mil Area of Conductors

K = 10.75 (Constant representing the mil-foot resistance of copper)

I = Current - amps

L = Length - feet

E = Voltage drop at load
(drop x working voltage)

Length	Current (Amps)												
	5	10	15	20	25	30	40	50	60	70	80	90	100
10'	3 m	18	14	12	10	10	8	6	6	6	6	4	4
15'	5 m	16	12	10	10	8	8	6	6	4	4	2	2
20'	6 m	14	10	10	8	6	6	6	4	4	2	2	2
25'	8 m	12	10	8	6	6	6	4	4	2	2	1	1
30'	9 m	12	10	8	6	4	4	4	2	2	2	1	1
40'	12 m	10	8	6	6	4	4	2	2	1	1/0	1/0	2/0
50'	15 m	10	6	6	4	4	2	2	1	1/0	2/0	3/0	4/0
60'	18 m	10	6	6	4	2	2	1	1/0	2/0	3/0	3/0	4/0
70'	21 m	8	6	4	2	2	1	1/0	2/0	3/0	3/0	4/0	4/0
80'	24 m	8	6	4	2	2	1	1/0	2/0	3/0	4/0	4/0	
90'	27 m	8	4	2	2	1	1/0	2/0	3/0	4/0	4/0		
100'	30 m	6	4	2	2	1	1/0	2/0	3/0	4/0			
110'	33 m	6	4	2	2	1	1/0	2/0	3/0	4/0			
120'	36 m	6	4	2	1	1/0	2/0	3/0	4/0				
130'	40 m	6	2	2	1	1/0	2/0	3/0	4/0				
140'	43 m	6	2	2	1/0	2/0	3/0	4/0					
150'	46 m	6	2	1	1/0	2/0	3/0	4/0					
160'	49 m	6	2	1	1/0	2/0	3/0	4/0					
170'	52 m	6	2	1	2/0	3/0	3/0	4/0					

3% Voltage Drop at 24 Volts

Length	Current (Amps)												
	5	10	15	20	25	30	40	50	60	70	80	90	100
10'	3 m	18	18	16	14	12	12	10	10	8	8	8	6
15'	5 m	18	16	14	12	12	10	10	8	8	6	6	6
20'	6 m	18	14	12	10	10	10	8	6	6	6	4	4
25'	8 m	16	12	12	10	10	8	6	6	4	4	4	4
30'	9 m	16	12	10	10	8	8	6	6	4	4	2	2
40'	12 m	14	10	10	8	6	6	6	4	4	2	2	2
50'	15 m	12	10	8	6	6	6	4	4	2	2	1	1
60'	18 m	12	10	8	6	6	4	4	2	2	1	1/0	1/0
70'	21 m	12	8	6	6	4	4	2	2	1	1	1/0	1/0
80'	24 m	10	8	6	6	4	4	2	2	1	1/0	1/0	2/0
90'	27 m	10	8	6	4	4	2	2	1	1/0	1/0	2/0	2/0
100'	30 m	10	6	6	4	4	2	2	1	1/0	2/0	2/0	3/0
110'	33 m	10	6	6	4	2	2	1	1/0	1/0	2/0	3/0	3/0
120'	36 m	10	6	4	4	2	2	1	1/0	2/0	3/0	3/0	4/0
130'	40 m	8	6	4	2	2	2	1	1/0	2/0	3/0	3/0	4/0
140'	43 m	8	6	4	2	2	1	1/0	2/0	3/0	3/0	4/0	4/0
150'	46 m	8	6	4	2	2	1	1/0	2/0	3/0	3/0	4/0	4/0
160'	49 m	8	6	4	2	2	1	1/0	2/0	3/0	4/0	4/0	4/0
170'	52 m	8	6	2	2	1	1	2/0	3/0	3/0	4/0	4/0	

3% Voltage Drop at 32 Volts

Length	Current (Amps)												
	5	10	15	20	25	30	40	50	60	70	80	90	100
10'	3 m	18	18	16	16	14	12	12	10	10	10	8	8
15'	5 m	18	16	14	14	12	12	10	10	8	8	6	6
20'	6 m	18	16	12	12	12	10	10	8	8	6	6	6
25'	8 m	18	14	12	12	10	10	8	8	6	6	6	4
30'	9 m	16	14	10	10	10	8	8	6	6	4	4	4
40'	12 m	16	12	10	10	8	8	6	6	4	4	2	2
50'	15 m	14	12	8	8	8	6	6	4	4	2	2	2
60'	18 m	14	10	8	8	6	6	4	4	2	2	2	1
70'	21 m	12	10	6	6	6	6	4	2	2	1	1	0
80'	24 m	12	10	6	6	6	4	4	2	2	1	1	0
90'	27 m	12	8	6	6	6	4	2	2	1	1/0	1/0	2/0
100'	30 m	12	8	6	6	4	4	2	2	1	1/0	1/0	2/0
110'	33 m	10	8	6	6	4	4	2	2	1	1/0	1/0	2/0
120'	36 m	10	8	6	4	4	2	2	1	1/0	1/0	2/0	3/0
130'	40 m	10	8	6	4	4	2	2	1	1/0	2/0	2/0	3/0
140'	43 m	10	6	6	4	2	2	1	1/0	1/0	2/0	3/0	3/0
150'	46 m	10	6	6	4	2	1	1	1/0	2/0	2/0	3/0	4/0
160'	49 m	10	6	4	4	2	1	1	1/0	2/0	3/0	3/0	4/0
170'	52 m	8	6	4	2	2	1	1	1/0	2/0	3/0	3/0	4/0

TECH TIP

ABYC Recommends...

"Conductors used for panelboard or switchboard main feeders, bilge blowers, electronic equipment, navigation lights, and other circuits where voltage drop must be kept to a minimum, shall be sized for a voltage drop not to exceed three percent."
ABYC 11.16.1.2.7.

Conductors Sized (AWG) for 10% Voltage Drop

10% Voltage Drop at 12 Volts

Length	Current (Amps)												
	5	10	15	20	25	30	40	50	60	70	80	90	100
10'	3 m	18	18	18	16	16	14	14	12	12	10	10	10
15'	5 m	18	18	16	14	14	12	12	10	10	8	8	8
20'	6 m	18	16	14	14	12	12	10	10	8	8	6	6
25'	8 m	18	16	14	12	12	10	10	8	8	6	6	6
30'	9 m	18	14	12	12	10	10	8	8	6	6	6	4
40'	12 m	16	14	12	10	10	8	8	6	6	6	4	4
50'	15 m	16	12	10	10	8	8	6	6	4	4	4	2
60'	18 m	14	12	10	8	8	6	6	4	4	2	2	2
70'	21 m	14	10	8	8	6	6	6	4	2	2	2	1
80'	24 m	14	10	8	8	6	6	4	4	2	2	2	1
90'	27 m	12	10	8	6	6	6	4	2	2	2	1	1
100'	30 m	12	10	8	6	6	4	4	2	2	1	1	1/0
110'	33 m	12	8	8	6	6	4	2	2	2	1	1/0	1/0
120'	36 m	12	8	6	6	4	4	2	2	1	1	1/0	1/0
130'	40 m	12	8	6	6	4	4	2	2	1	1/0	1/0	2/0
140'	43 m	10	8	6	6	4	2	2	1	1	1/0	2/0	2/0
150'	46 m	10	8	6	4	4	2	2	1	1/0	1/0	2/0	2/0
160'	49 m	10	8	6	4	4	2	2	1	1/0	2/0	2/0	3/0
170'	52 m	10	6	6	4	2	2	2	1	1/0	2/0	2/0	3/0

Use 10% voltage drop for any "non-critical" applications: windlass, cabin lights, etc....

For Example...

Q: A bilge pump draws 10 amps. The positive run is 11 feet from the power panel, including the float switch. The negative run is only 10 feet. What size is the wire?

A: Use the formula to reach the correct answer:

$$CM = \frac{10.75 \times 10 \text{ (amps)} \times 21 \text{ (total length of run)}}{0.36 \text{ (3\% of 12V)}} = 6,271$$

Ancor cable specifications show that 12 AWG wire has a CM area of 6,500 and is the correct choice. However, SAE wire has a CM area of only 5,833. Under NFPA and USCG regulations, 10 SAE wire must be used.

TECH TIP

ABYC Recommends...

"Conductors used for lighting, other than navigation lights, and other circuits where voltage drop is not critical, shall be sized for a voltage drop not to exceed 10 percent." ABYC 11.16.1.2.7.

10% Voltage Drop at 24 Volts

Length	Current (Amps)												
	5	10	15	20	25	30	40	50	60	70	80	90	100
10'	3 m	18	18	18	18	18	18	16	16	14	14	14	12
15'	5 m	18	18	18	18	16	16	14	14	12	12	12	10
20'	6 m	18	18	18	16	16	14	14	12	12	10	10	10
25'	8 m	18	18	16	16	14	14	12	12	10	10	10	8
30'	9 m	18	18	16	14	14	12	12	10	10	8	8	8
40'	12 m	18	16	14	14	12	12	10	10	8	8	6	6
50'	15 m	18	16	14	12	12	10	10	8	8	6	6	6
60'	18 m	18	14	12	12	10	10	8	8	6	6	6	4
70'	21 m	16	14	12	10	10	8	8	6	6	6	4	4
80'	24 m	16	14	12	10	10	8	8	6	6	6	4	4
90'	27 m	16	12	10	10	8	8	6	6	6	4	4	2
100'	30 m	16	12	10	10	8	8	6	6	4	4	4	2
110'	33 m	14	12	10	8	8	8	6	6	4	4	2	2
120'	36 m	14	12	10	8	8	6	6	4	4	2	2	2
130'	40 m	14	12	10	8	8	6	6	4	4	2	2	2
140'	43 m	14	10	8	8	6	6	6	4	2	2	2	1
150'	46 m	14	10	8	8	6	6	4	4	2	2	2	1
160'	49 m	14	10	8	8	6	6	4	4	2	2	2	1
170'	52 m	12	10	8	6	6	6	4	2	2	2	1	1

10% Voltage Drop at 32 Volts

Length	Current (Amps)												
	5	10	15	20	25	30	40	50	60	70	80	90	100
10'	3 m	18	18	18	18	18	18	16	16	14	14	14	14
15'	5 m	18	18	18	18	18	18	16	14	14	14	12	12
20'	6 m	18	18	18	18	16	16	14	14	12	12	12	10
25'	8 m	18	18	18	16	16	14	14	12	12	10	10	10
30'	9 m	18	18	18	16	14	14	12	14	10	10	10	8
40'	12 m	18	18	16	14	14	12	12	10	10	8	8	8
50'	15 m	18	16	14	14	12	12	10	10	8	8	8	6
60'	18 m	18	16	14	12	12	10	10	8	8	8	6	6
70'	21 m	18	14	14	12	10	10	8	8	8	6	6	6
80'	24 m	18	14	12	12	10	10	8	8	6	6	6	4
90'	27 m	18	14	12	10	10	10	8	6	6	6	4	4
100'	30 m	16	14	12	10	10	8	8	6	6	6	4	4
110'	33 m	16	14	12	10	10	8	8	6	6	6	4	4
120'	36 m	16	12	10	10	8	8	6	6	6	4	4	2
130'	40 m	16	12	10	10	8	8	6	6	6	4	4	2
140'	43 m	14	12	10	8	8	8	6	6	4	4	2	2
150'	46 m	14	12	10	8	8	6	6	6	4	4	2	2
160'	49 m	14	12	10	8	8	6	6	4	4	2	2	2
170'	52 m	14	12	10	8	8	6	6	4	4	2	2	2

18–4/0 AWG Wire and Cable Specifications

AWG	mm ²	AWG CM area	SAE CM area	Ampacity Engine Space	
				Outside	Inside
18	0.8	1,600	1,537	20	17
16	1	2,600	2,336	25	21
14	2	4,100	3,702	35	30
12	3	6,500	5,833	45	38
10	5	10,500	9,343	60	51
8	8	16,800	14,810	80	68
6	13	26,600	24,538	120	102
4	21	42,000	37,360	160	136
2	34	66,500	62,450	210	178
1	42	83,690	77,790	245	208
1/0	53	105,600	98,980	285	242
2/0	68	133,100	125,100	330	280
3/0	85	167,800	158,600	385	327
4/0	107	211,600	205,500	445	378

Temperature Rating of Conductor Insulation

The Law

The Code of Federal Regulations (CFR) 183.425 Conductors

(b) Except for intermittent surges each conductor must not carry a current greater than that specified for the conductor's gauge and temperature rating.

(c) For conductors in engine spaces, amperages must be corrected by the appropriate correction factor in Note 1.

Due to engine heat, the ambient temperature in engine spaces is usually higher than in other spaces of the boat. Wiring in and passing through engine spaces must be able to operate at these higher ambient temperatures. The ampacity values are based on an ambient temperature of 86°F / 30°C which is considered reasonable for use on boats except in engine spaces. The correction factors in Note 1 converts the ampacities to acceptable values in an ambient temperature of 122°F / 50°C. This higher temperature has been selected as satisfactory for engine spaces. Note 1 is supplied to eliminate the need for calculating the corrections. The values are already corrected.

Conductor Size AWG	Ampacity Outside of Engine Space	Ampacity Inside of Engine Space (Note 1)
18	20	17
16	25	21
14	35	30
12	45	38
10	60	51
8	80	68
6	120	102
4	160	136
3	180	153
2	210	178
1	245	208
1/0	285	242
2/0	330	280
3/0	385	327
4/0	445	378

*De-rating for engine space is 0.85 for 221°F / 105°C rated wire.

Allowable Amperage of Conductors of 50 Volts or More

The current values shown in this chart and also on the wire and cable specifications chart do not consider voltage drop for conductors under 50 volts. The values shown on the ampacity table are the maximum safe amperages which the conductor can carry on a continuous basis. They do not apply to intermittent starting loads such as motor start currents. Since all Ancor Boat Cable is 105°C insulated, only that temperature rating is shown.

Due to the higher ambient temperatures in engine spaces and the heat retention of large wire bundles, a “correction factor” must be used to de rate the wire by increasing conductor size. This chart takes into consideration these factors and should be used to select conductor sizes for circuits over 50 volts. Note that for electrical systems under 50 volts, voltage drop is the controlling factor and the tables on 62 and 63 should be used.

Conductor Size AWG	2 Conductors 221°F (105°C) Engine Space		3 Conductors 221°F (105°C) Engine Space		4-6 Conductors 221°F (105°C) Engine Space		7-24 Conductors 221°F (105°C) Engine Space	
	Outside	Inside	Outside	Inside	Outside	Inside	Outside	Inside
18	20	17.0	14.0	11.9	12.0	10.2	10.0	8.5
16	25	21.3	17.5	14.9	15.0	12.8	12.5	10.6
14	35	29.8	24.5	20.8	21.0	17.9	17.5	14.9
12	45	38.3	31.5	26.8	27.0	23.0	22.5	19.1
10	60	51.0	42.0	35.7	36.0	30.6	30.0	25.5
8	80	68.0	56.0	47.6	48.0	40.8	40.0	34.0
6	120	102.0	84.0	71.4	72.0	61.2	60.0	51.0
4	160	136.0	112.0	95.2	96.0	81.6	80.0	68.0
3	180	153.0	126.0	107.1	108.0	91.8	90.0	76.5
2	210	178.5	147.0	125.0	126.0	107.1	105.0	89.3
1	245	208.3	171.5	145.8	147.0	125.0	122.5	104.1
1/0	285	242.3	199.5	169.6	171.0	145.4	142.5	121.1
2/0	330	280.5	231.0	196.4	198.0	168.3	165.0	140.3
3/0	385	327.3	269.5	229.1	231.0	196.4	192.5	163.6
4/0	445	378.3	311.5	264.8	267.0	227.0	222.5	189.1

Number of current carrying conductors:	Correction Factor
3	0.70
4 to 6	0.60
7 to 24	0.50
25 and above	0.40

This table is supplied to eliminate the need for calculating the corrections for multi-conductor cable bundles in the temperature rating chart. The values are already corrected.

Note: These tables only apply for 221°F (105°C) wire and other premium wire and should not be used for lesser grades of wire and cable.

Reprinted at the courtesy of the United States Coast Guard Electrical System Compliance Guideline.

* There is NO LIMIT on conductors in a bundle under 50 volts.



Use the Circuit Wizard to easily identify what wire to use. Scan the code or go to ancorproducts.com/circuit_wizard

PN	Page	PN	Page	PN	Page	PN	Page	PN	Page
100010	8	101825	8	103025	8	104925	8	106802	9
100025	8	101850	8	103050	8	104950	8	106810	9
100050	8	101910	8	103099	8	104999	8	106825	9
100099	8	101925	8	103810	8	105010	8	106840	9
100110	8	101950	8	103825	8	105025	8	106899	9
100125	8	102010	8	103850	8	105050	8	106902	9
100150	8	102025	8	103910	8	105099	8	106910	9
100199	8	102050	8	103925	8	105810	9	106925	9
100210	8	102099	8	103950	8	105825	9	106940	9
100225	8	102110	8	104010	8	105840	9	106999	9
100299	8	102125	8	104025	8	106002	9	107002	9
100310	8	102150	8	104050	8	106010	9	107010	9
100325	8	102199	8	104099	8	106025	9	107025	9
100350	8	102210	8	104110	8	106040	9	107040	9
100399	8	102225	8	104125	8	106099	9	107099	9
100410	8	102250	8	104150	8	106102	9	108002	9
100425	8	102299	8	104199	8	106110	9	108010	9
100450	8	102310	8	104210	8	106125	9	108025	9
100499	8	102350	8	104225	8	106140	9	108050	9
100510	8	102399	8	104250	8	106199	9	108099	9
100525	8	102410	8	104299	8	106202	9	108102	9
100550	8	102425	8	104310	8	106210	9	108110	9
100599	8	102450	8	104325	8	106225	9	108125	9
100610	8	102499	8	104350	8	106240	9	108150	9
100625	8	102510	8	104399	8	106299	9	108199	9
100650	8	102525	8	104410	8	106302	9	108202	9
100699	8	102550	8	104425	8	106310	9	108210	9
100710	8	102599	8	104450	8	106325	9	108225	9
100725	8	102610	8	104499	8	106340	9	108250	9
100750	8	102625	8	104510	8	106399	9	108299	9
100799	8	102650	8	104525	8	106499	9	108302	9
100810	8	102710	8	104550	8	106502	9	108310	9
100825	8	102725	8	104599	8	106510	9	108325	9
100850	8	102750	8	104610	8	106525	9	108350	9
100899	8	102799	8	104625	8	106540	9	108399	9
100910	8	102810	8	104650	8	106599	9	108499	9
100925	8	102825	8	104710	8	106602	9	108502	9
100950	8	102850	8	104725	8	106610	9	108510	9
100999	8	102899	8	104750	8	106625	9	108525	9
101010	8	102910	8	104810	8	106640	9	108550	9
101025	8	102925	8	104825	8	106702	9	108599	9
101050	8	102950	8	104850	8	106710	9	108802	9
101099	8	102999	8	104899	8	106725	9	108810	9
101810	8	103010	8	104910	8	106740	9	108825	9

PN	Page	PN	Page	PN	Page	PN	Page	PN	Page
108850	9	111925	9	113905	10	117005	10	121310	12
108899	9	111950	9	113910	10	117010	10	121325	12
108902	9	111999	9	113925	10	117020	10	121350	12
108910	9	112002	9	113950	10	117502	10	121510	12
108925	9	112005	9	114002	10	117505	10	121525	12
108950	9	112010	9	114005	10	117510	10	121550	12
108999	9	112025	9	114010	10	117520	10	121599	12
109002	9	112050	9	114025	10	117902	10	121610	14
109010	9	112075	9	114040	10	117905	10	121625	14
109025	9	112302	9	114502	10	117910	10	121710	12
109050	9	112305	9	114505	10	117920	10	121725	12
109099	9	112310	9	114510	10	118002	10	121750	12
109302	9	112325	9	114525	10	118005	10	121799	12
109310	9	112350	9	114540	10	118010	10	121802	14
109325	9	112375	9	114902	10	118015	10	121810	14
109350	9	112502	9	114905	10	118502	10	121825	14
109399	9	112505	9	114910	10	118505	10	121910	12
111002	9	112510	9	114925	10	118510	10	121925	12
111005	9	112525	9	114940	10	118515	10	121950	12
111010	9	112550	9	115002	10	118902	10	122010	14
111025	9	112575	9	115005	10	118905	10	122025	14
111050	9	112702	9	115010	10	118910	10	122050	14
111099	9	112705	9	115030	10	118915	10	123705	12
111302	9	112710	9	115502	10	119002	10	123710	12
111305	9	112725	9	115505	10	119005	10	123905	12
111310	9	112750	9	115510	10	119010	10	123910	12
111325	9	112775	9	115530	10	119025	10	123950	12
111350	9	112902	9	115902	10	119502	10	124102	12
111399	9	112905	9	115905	10	119505	10	124110	12
111502	9	112910	9	115910	10	119510	10	124125	12
111505	9	112925	9	115930	10	119525	10	124140	12
111510	9	112950	9	116002	10	119902	10	124180	12
111525	9	112975	9	116005	10	119905	10	124302	12
111550	9	113002	10	116010	10	119910	10	124310	12
111599	9	113005	10	116025	10	119925	10	124325	12
111702	9	113010	10	116502	10	120705	12	124350	12
111705	9	113025	10	116505	10	120710	12	124502	12
111710	9	113050	10	116510	10	120905	12	124510	12
111725	9	113502	10	116525	10	120910	12	124525	12
111750	9	113505	10	116902	10	120925	12	124550	12
111799	9	113510	10	116905	10	121110	12	124599	12
111902	9	113525	10	116910	10	121125	12	124702	12
111905	9	113550	10	116925	10	121140	12	124710	12
111910	9	113902	10	117002	10	121180	12	124725	12

PN	Page	PN	Page	PN	Page	PN	Page	PN	Page
124750	12	142410	15	160210	15	188803	9	199228	40
124799	12	142425	15	160299	15	189130	11	199229	40
124910	12	142499	15	170002	15	189131	11	199230	40
124925	12	142610	15	170010	15	189134	11	199231	40
124950	12	142625	15	170025	15	189135	11	199232	40
124999	12	142650	15	180003	8	189136	11	199233	40
126310	12	142810	15	180103	8	189137	11	199234	40
126325	12	150102	15	180203	8	189140	11	199235	40
126350	12	150110	15	180303	8	189141	11	199236	40
126510	12	150510	16	180403	8	189144	11	199245	40
126525	12	150525	16	180503	8	189145	11	199246	39
126550	12	151025	16	180603	8	189146	11	199247	39
126710	12	151050	16	180703	8	189147	11	199248	39
126725	12	151510	16	180803	8	189303	14	199249	39
126750	12	151525	16	180903	8	189800	16	199250	40
130705	13	151550	16	181003	8	189849	16	199251	40
130710	13	151560	16	182003	8	199200	39	199252	40
130902	13	151710	16	182103	8	199201	39	199253	40
130905	13	151725	16	182203	8	199202	39	199254	39
130910	13	151750	16	182303	8	199203	39	199257	40
131110	13	153010	14	182403	8	199204	39	199258	40
131130	13	153050	14	182503	8	199205	39	199259	39
131150	13	153110	14	182603	8	199206	39	199260	39
131302	13	153125	14	182703	8	199207	39	199261	40
131310	13	153150	14	182803	8	199208	39	199262	40
131325	13	153710	16	182903	8	199209	39	199263	40
131370	13	153725	16	183003	8	199210	39	199264	41
131510	13	154010	17	184003	8	199211	39	199265	41
131525	13	154030	17	184103	8	199212	39	199266	41
131550	13	154510	17	184203	8	199213	39	199267	41
131590	13	154525	17	184303	8	199214	39	199268	41
131710	13	155010	14	184403	8	199215	39	199269	41
131725	13	155050	14	184503	8	199216	39	199274	41
131750	13	156410	15	184603	8	199217	39	199275	41
131799	13	156425	15	184703	8	199218	39	199276	41
133310	13	156450	15	184803	8	199219	39	199277	41
133325	13	156610	15	184903	8	199220	39	199278	41
133510	13	156625	15	185003	8	199221	39	199279	41
133525	13	158010	14	186003	9	199222	39	199280	41
133590	13	158025	14	186303	9	199223	39	199281	41
133710	13	160010	15	186803	9	199224	40	199282	41
133725	13	160099	15	186903	9	199225	40	199283	41
141410	14	160110	15	187003	9	199226	40	199284	41
141425	14	160199	15	188003	9	199227	40	199285	41

PN	Page	PN	Page	PN	Page	PN	Page	PN	Page
199300	42	210203	27	210808	28	220809	28	230215	27
199301	42	210204	27	210809	28	220818	28	230216	27
199302	42	210205	27	210818	28	220819	28	230221	27
199303	42	210206	27	210819	28	220828	28	230222	27
199304	42	210211	27	210828	28	220829	28	230223	27
199305	42	210212	27	210829	28	221408	28	230224	27
199306	42	210213	27	211408	28	221409	28	230225	27
199307	42	210214	27	211409	28	221418	28	230226	27
199308	42	210215	27	211418	28	221419	28	230227	27
199309	42	210216	27	211419	28	221428	28	230233	27
199310	42	210221	27	211428	28	221429	28	230234	27
199311	42	210222	27	211429	28	222100	28	230235	27
199312	42	210223	27	211601	28	222110	28	230236	27
199313	42	210224	27	211611	28	222120	28	230237	27
199314	42	210225	27	211621	28	222161	28	230243	27
199315	42	210226	27	220003	45	222162	28	230244	27
199316	42	210227	27	220011	25	222163	28	230245	27
199317	42	210233	27	220100	28	222213	27	230246	27
199324	40	210234	27	220110	28	222233	27	230247	27
199325	40	210235	27	220120	28	222234	27	230301	28
199328	40	210236	27	220161	28	222235	27	230302	28
199329	40	210237	27	220162	28	222236	27	230303	28
199333	41	210243	27	220163	28	230100	28	230311	28
199334	41	210244	27	220202	27	230110	28	230312	28
199336	41	210245	27	220203	27	230120	28	230313	28
199337	41	210246	27	220212	27	230130	29	230322	28
199339	41	210247	27	220213	27	230140	29	230323	28
199340	41	210301	28	220214	27	230150	29	230510	29
199342	41	210302	28	220215	27	230161	28	230520	29
199343	41	210303	28	220216	27	230162	28	230602	29
210100	28	210311	28	220222	27	230163	28	230612	29
210110	28	210312	28	220223	27	230164	29	230613	29
210120	28	210313	28	220224	27	230165	29	230622	29
210130	29	210322	28	220225	27	230166	29	230708	29
210140	29	210323	28	220226	27	230201	27	230709	29
210150	29	210510	29	220312	28	230202	27	230718	29
210161	28	210520	29	220313	28	230203	27	230719	29
210162	28	210612	29	220323	28	230204	27	230808	28
210163	28	210613	29	220602	29	230205	27	230809	28
210164	29	210622	29	220612	29	230206	27	230818	28
210165	29	210708	29	220622	29	230211	27	230819	28
210166	29	210709	29	220718	29	230212	27	230828	28
210201	27	210718	29	220719	29	230213	27	230829	28
210202	27	210719	29	220808	28	230214	27	231408	28

PN	Page	PN	Page	PN	Page	PN	Page	PN	Page
231409	28	242296	30	252243	30	262245	31	301124	36
231418	28	242297	30	252244	30	262246	31	301148	36
231419	28	242715	30	252245	30	262255	31	301503	36
231428	28	242716	30	252246	30	262256	31	301506	36
231429	28	242717	30	252247	30	262265	31	302103	36
231601	28	242725	30	252251	30	262266	31	302106	36
231611	28	242726	30	252253	30	262275	31	302124	36
231621	28	242727	30	252254	30	262276	31	302148	36
242130	31	244233	30	252255	30	262285	31	302603	36
242140	31	244234	30	252256	30	262286	31	302606	36
242150	31	244235	30	252257	30	262295	31	302624	36
242160	31	244236	30	252261	30	262296	31	302648	36
242170	31	244244	30	252264	30	262715	31	303103	36
242180	31	244245	30	252265	30	262716	31	303106	36
242190	31	244246	30	252266	30	262725	31	303124	36
242233	30	244254	30	252267	30	262726	31	303148	36
242234	30	244255	30	252274	30	270000	18	303602	36
242235	30	244256	30	252275	30	270001	18	303603	36
242236	30	244265	30	252276	30	270002	18	303606	36
242237	30	244266	30	252277	30	270005	18	303624	36
242243	30	244275	30	252284	30	270010	18	303648	36
242244	30	244276	30	252285	30	270101	19	304103	36
242245	30	244285	30	252286	30	270103	19	304106	36
242246	30	244286	30	252287	30	270104	19	304124	36
242247	30	244295	30	252294	30	270105	19	304148	36
242253	30	244296	30	252295	30	270106	19	304503	36
242254	30	244725	30	252296	30	270107	19	304506	36
242255	30	244726	30	252297	30	270108	19	304602	36
242256	30	249101	17	252715	30	270109	19	304603	36
242257	30	249102	17	252716	30	270110	19	304606	36
242264	30	250101	45	252717	30	270111	19	304624	36
242265	30	252130	31	252725	30	270112	19	304648	36
242266	30	252140	31	252726	30	270113	19	305103	36
242267	30	252150	31	252727	30	270114	19	305106	36
242274	30	252160	31	255101	45	270201	20	305124	36
242275	30	252170	31	260010	32	270202	20	305148	36
242276	30	252180	31	260012	32	270203	21	305602	36
242277	30	252190	31	260100	32	270300	18	305603	36
242284	30	252233	30	260200	32	270301	18	305606	36
242285	30	252234	30	260322	32	270302	18	305624	36
242286	30	252235	30	260325	32	270305	18	305648	36
242287	30	252236	30	260350	32	270400	66	306103	36
242294	30	252237	30	260381	32	301103	36	306106	36
242295	30	252241	30	260505	33	301106	36	306124	36

PN	Page	PN	Page	PN	Page	PN	Page	PN	Page
306148	36	310225	24	313203	24	320125	25	336899	26
306503	36	310299	24	313225	24	320203	25	337066	38
306602	36	310303	24	313299	24	320225	25	337899	26
306603	36	310325	24	314203	24	320303	25	339066	38
306606	36	310399	24	314225	24	320325	25	341010	38
306624	36	310403	24	314299	24	320803	26	343010	38
306648	36	310425	24	314303	24	320825	26	346010	38
306903	36	310499	24	314325	24	320899	26	347010	38
306906	36	310503	24	314399	24	320903	26	356803	26
306924	36	310525	24	315203	24	320925	26	356825	26
306948	36	310599	24	315225	24	320999	26	357803	26
307103	36	310603	24	315299	24	321303	24	357825	26
307106	36	310625	24	315303	24	321325	24	400000	43
307124	36	310699	24	315325	24	321403	24	401122	43
307148	36	311203	24	315399	24	321425	24	401182	43
307602	36	311225	24	316803	26	321503	24	401251	43
307603	36	311299	24	316825	26	321525	24	401252	43
307606	36	311303	24	316899	26	321603	24	401255	43
307624	36	311325	24	316903	26	321625	24	401312	43
307648	36	311399	24	316925	26	321703	24	401372	43
307903	36	311403	24	316999	26	321725	24	401375	43
307906	36	311425	24	317803	26	326103	37	401432	43
307924	36	311499	24	317825	26	326106	37	401502	43
307948	36	311503	24	317899	26	326124	37	401622	43
309000	25	311525	24	317903	26	326148	37	401752	43
309001	25	311599	24	317925	26	326202	37	401892	43
309002	25	311603	24	317999	26	326603	37	401912	43
309003	25	311625	24	318803	24	326606	37	401932	43
309025	25	311699	24	318825	24	326624	37	402252	43
309099	25	312203	24	318899	24	326648	37	402312	43
309101	25	312225	24	318903	24	326899	26	402372	43
309102	25	312299	24	318925	24	327103	37	402502	43
309103	25	312303	24	318999	24	327106	37	402622	43
309125	25	312325	24	319803	24	327124	37	402752	43
309199	25	312399	24	319825	24	327148	37	402892	43
309201	25	312403	24	319899	24	327202	37	403182	43
309202	25	312425	24	319903	24	327603	37	403252	43
309203	25	312499	24	319925	24	327606	37	403312	43
309225	25	312503	24	319999	24	327624	37	403372	43
309299	25	312525	24	320000	25	327648	37	403502	43
309302	25	312599	24	320003	25	327899	26	403562	43
309303	25	312603	24	320025	25	330101	45	403622	43
309325	25	312625	24	320101	45	331066	38	403752	43
310203	24	312699	24	320103	25	336066	38	403872	43

PN	Page	PN	Page	PN	Page
403892	43	703041	51	SPK2218	26
403902	43	703042	51	SPKKIT	26
404152	43	703050	50		
404172	43	703060	52		
404202	43	703072	54		
404252	43	703073	54		
404302	43	703075	49		
404352	43	703079	55		
452251	44	703112	51		
452381	44	710010	53		
452385	44	710020	53		
452501	44	710030	53		
452505	44	710040	53		
452751	44	711000	53		
452755	44	750000	44		
452900	44	760375	44		
452905	44	760500	44		
453382	44	764998	44		
453386	44	765000	44		
453502	44	765002	44		
453506	44	765004	44		
453752	44	765006	44		
453756	44	765010	44		
453901	44	765012	44		
453906	44	100250A	8		
700103	33	100319F	16		
700115	33	100320F	16		
702007	48	102325AA	8		
702008	48	121602A	14		
702027	52	210602A	29		
702030	49	ANCLAMP	66		
702031	49	ANCLUG	66		
702032	49	ANCNMEA	66		
702033	49	ANCSHRINK	66		
703005	48	ANCTERM	66		
703006	48	ANCWIRE	66		
703007	48	DR2218	65		
703010	50	DR2230	64		
703015	51	DR2425	65		
703023	52	P33406	45		
703024	52	P33407	45		
703030	50	P33412	45		
703035	51	SPC103	16		
703040	50	SPK1614	26		

Ingress Protection (IP) Ratings Guide







Example:

An IP65 rating can be determined using the adjacent table and example:

- The first number of the rating example, 6, in the gray column means the enclosure is dust tight
- The second number of the rating example, 5, in the blue column means the enclosure is protected against jets of water

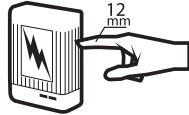
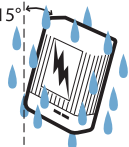
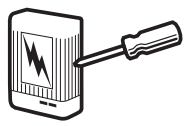
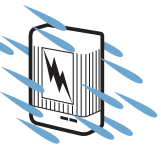
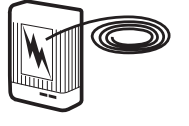
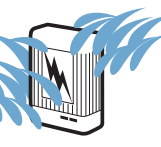
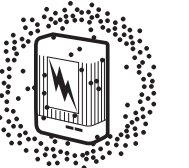
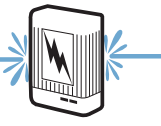
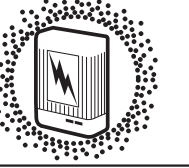
The IP rating system was established by the International Electrotechnical Commission (IEC), an organization for international standards and conformity assessment. The IEC collaborates closely with the International Organization for Standardization (ISO). A complete description of the IP ratings and associated tests is found in IEC Publication 529. Although these ratings were initially developed as a way to classify enclosures, they now provide a convenient, practical way to compare levels of sealing. Many electrical products have an Ingress Protection (IP) rating which identifies the environmental factors needing consideration prior to the product's installation.

This is important when deciding when to mount products in a dry and clean environment versus a wet and/or dusty environment. The IP rating indicates the degree of protection provided. The numbers following IP represent levels of sealing and can range from no protection to full protection against dust and water. The table provides a description of the protection at each level.

SOLIDS		WATER	
1	 Protected against a solid object greater than 50 mm such as a hand.	1	 Protected against vertically falling drops of water. Limited ingress permitted.
2	 Protected against a solid object greater than 12 mm such as a finger.	2	 Protected against vertically falling drops of water with enclosure tilted up to 15 degrees from the vertical. Limited ingress permitted.
3	 Protected against a solid object greater than 2.5 mm such as a screwdriver.	3	 Protected against sprays of water up to 60 degrees from the vertical. Limited ingress permitted for three minutes.
4	 Protected against a solid object greater than 1 mm such as a wire.	4	 Protected against water splashed from all directions. Limited ingress permitted.
5	 Dust Protected. Limited ingress of dust permitted. Will not interfere with operation of the equipment. Two to eight hours.	5	 Protected against jets of water. Limited ingress permitted.
6	 Dust tight. No ingress of dust. Two to eight hours.	6	 Water from heavy seas or water projected in powerful jets shall not enter the enclosure in harmful quantities.
		7	 Protection against the effects of immersion in water between 15 cm and 1 m for 30 minutes.
		8	 Protection against the effects of immersion in water under pressure for long periods.

Rating Example:

IP65

INGRESS PROTECTION



Ancor

N85 W12545 Westbrook Crossing
Menomonee Falls, WI 53051 USA
p 800.307.6702
f 800.799.3779

New Zealand

42 Apollo Drive
Rosedale, Auckland 0632
New Zealand
p +64.9.415.7261
f +64.9.415.9327

The Netherlands

Snijdersbergweg 93
1105 AN Amsterdam
The Netherlands
p +31(0)20 34 22 100
f +31(0)20 69 71 006

tech.marinco@oneasg.com
ancorproducts.com

© 2024 Navico Group. All Rights Reserved.
Navico Group is a division of Brunswick Corporation

®Reg. U.S. Pat. & Tm. Off, and ™ common law marks. Visit www.navico.com/intellectual-property to review the global trademark rights and accreditations for Navico Group and other entities.

Unauthorized copying or reproduction is a violation of applicable laws.

ANC-001-CAT-0423

FSC Details
(added by printers)